

Here is the  
most recent  
version of the  
installation video



Here you  
have the  
most recent  
version of the  
installation guide



## **INSTALLATION GUIDE**

# **10 - STEPS ALUMINUM STAIR STRINGER**

(COLLECTION 10) - 9-1/16"

**# 14030**



### **Question? - Contact us:**

First contact our friendly customer service team for assistance.

Email: [info@pylex.com](mailto:info@pylex.com) or call: 1-800-264-1881

Monday to Friday: 8:30am to 4:30pm UTC

Replacement for damaged or missing parts will be shipped promptly.

Rev.: 42-0523



**BEGINNER**

**EXPERIENCED**

**DECK AND FENCE HARDWARE**

**WWW.PYLEX.COM / 1 800-264-1881**

# BEFORE YOU START IMPORTANT MEASURES

**NUMBERS OF STRINGERS - RESIDENTIAL USE : ON STAIRCASE WIDTH**

**24" - 60" : 2 stringers**

**61" and + : 1 stringer every 36" max**

**FOR COMMERCIAL USE - PLEASE CONTACT US.**

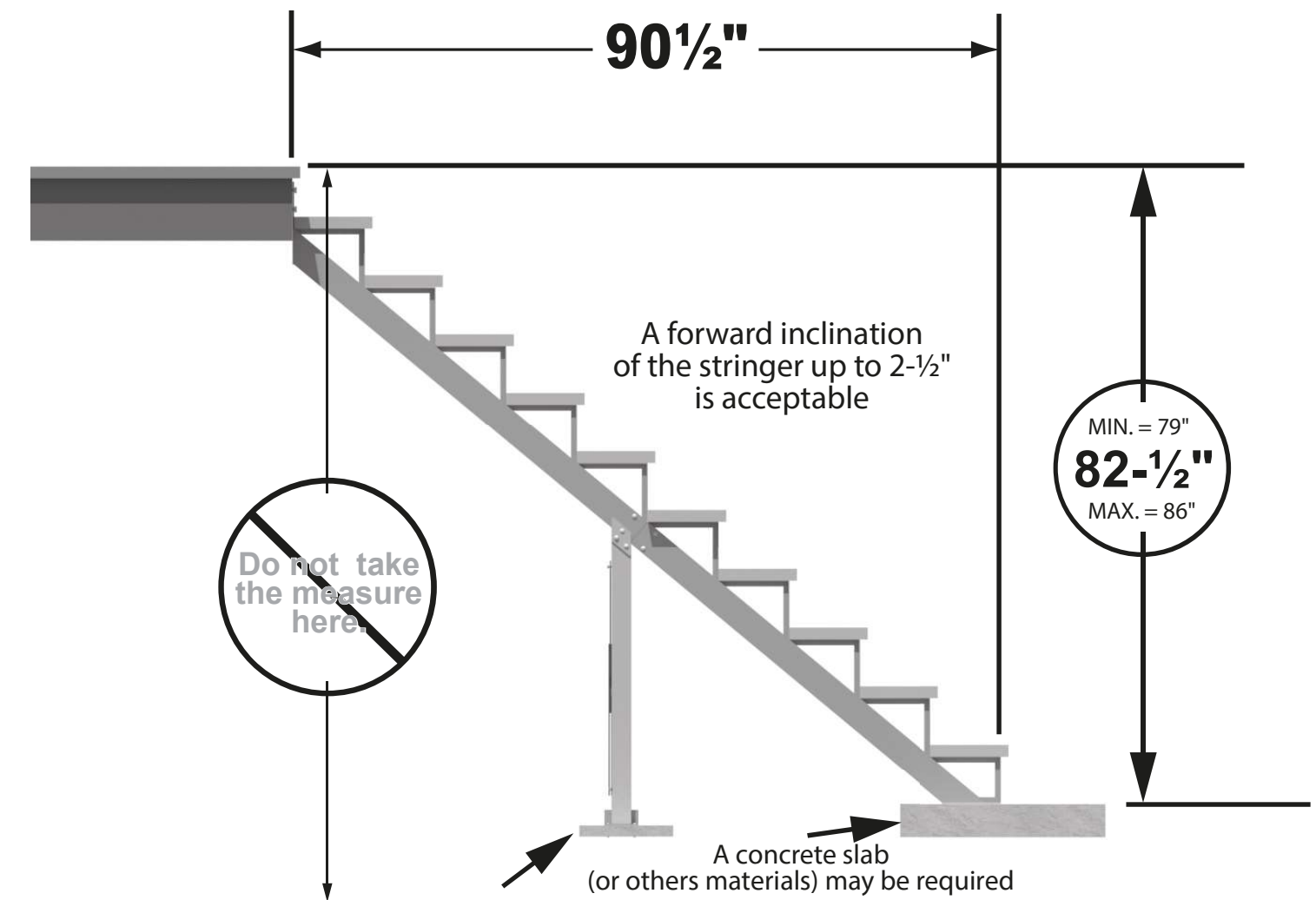

Before installing this product, make sure it complies with local building codes. Check with your municipality to avoid reaching underground or public installations. This product can be potentially dangerous if used improperly. Produits Pylex is not responsible for any damage or loss caused by the use of this product.

## PARTS LIST

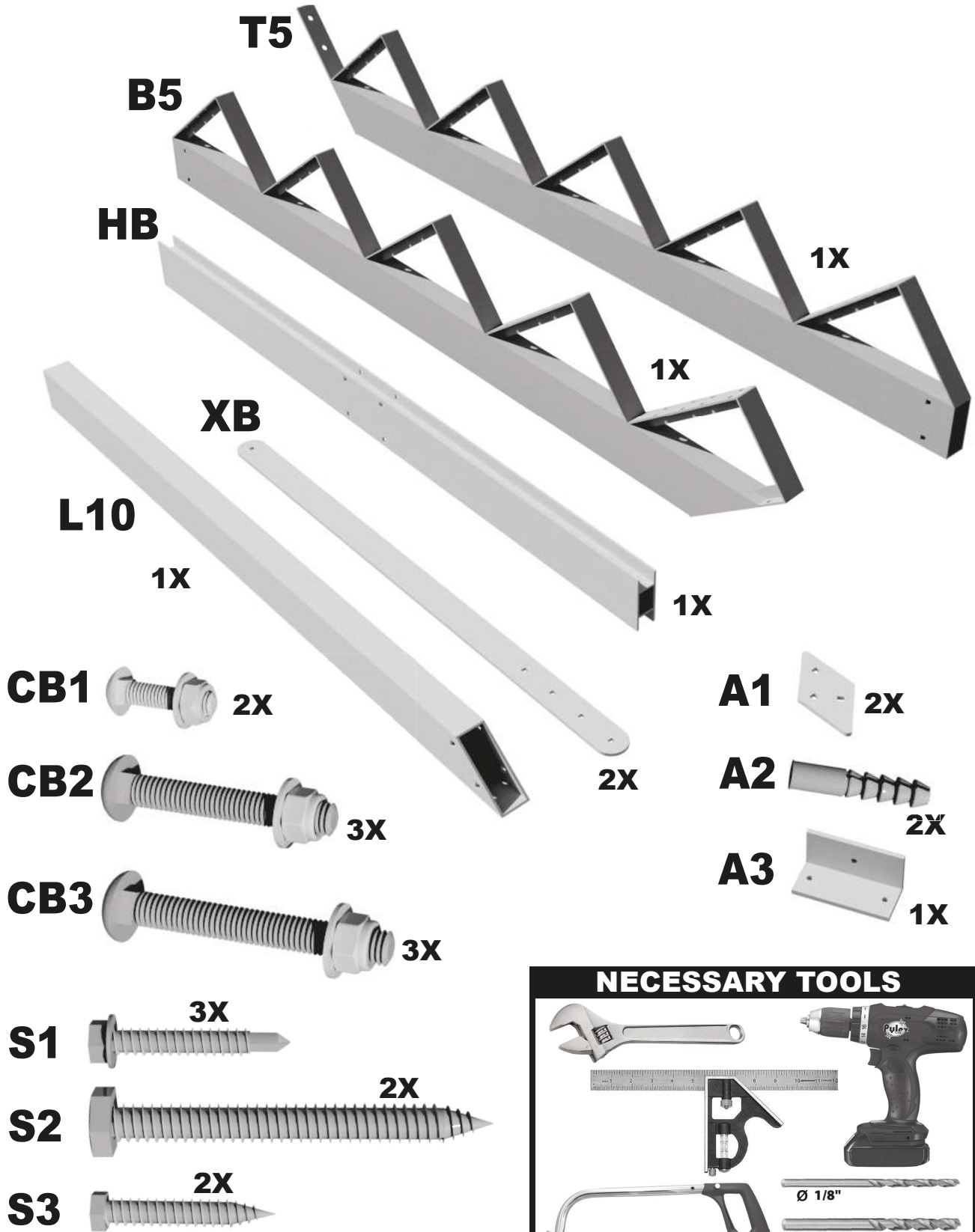

**STEP 1**

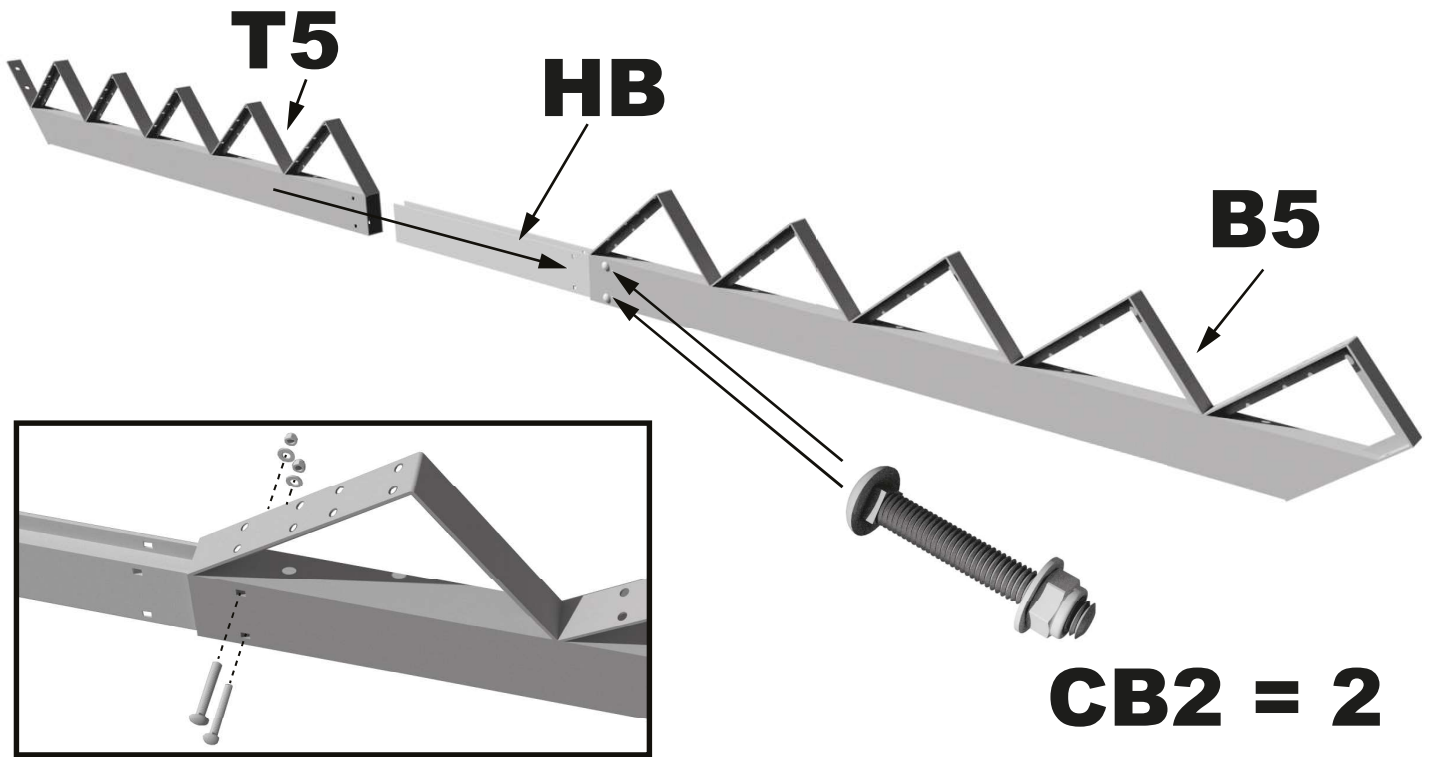

**STEP 2**

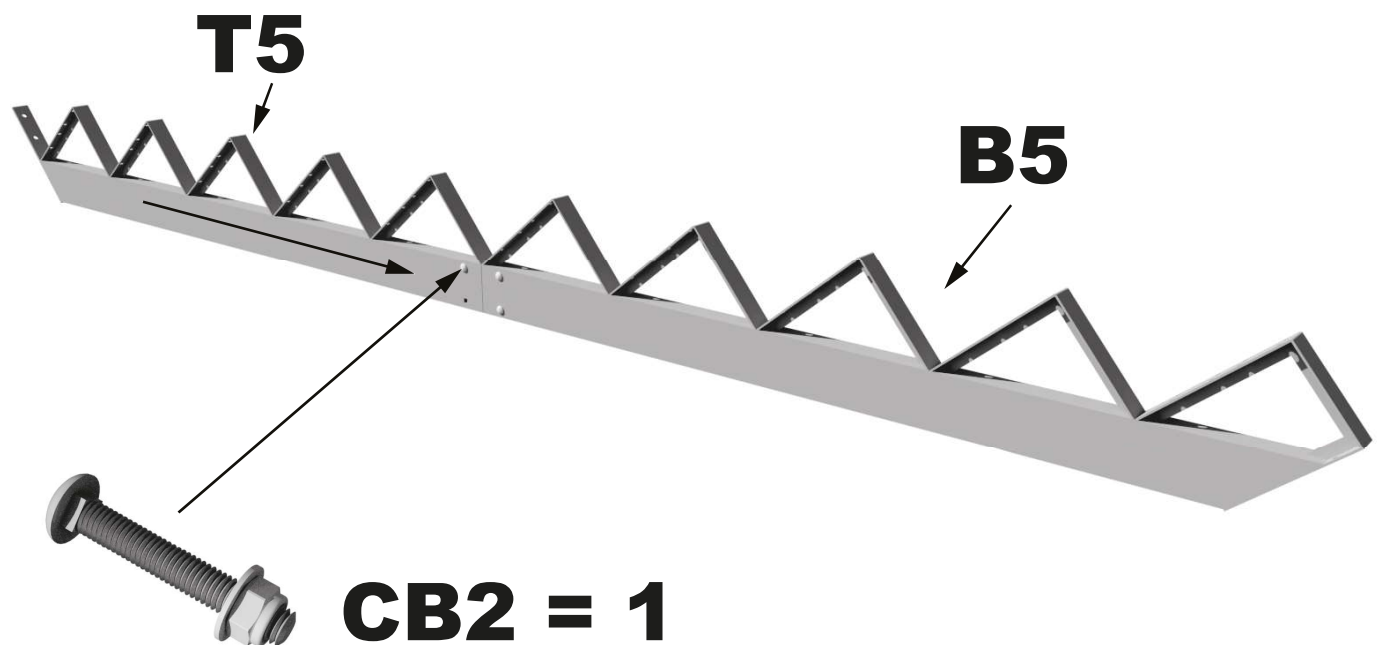

### STEP 3 - A1 PLATE INSTALLATION

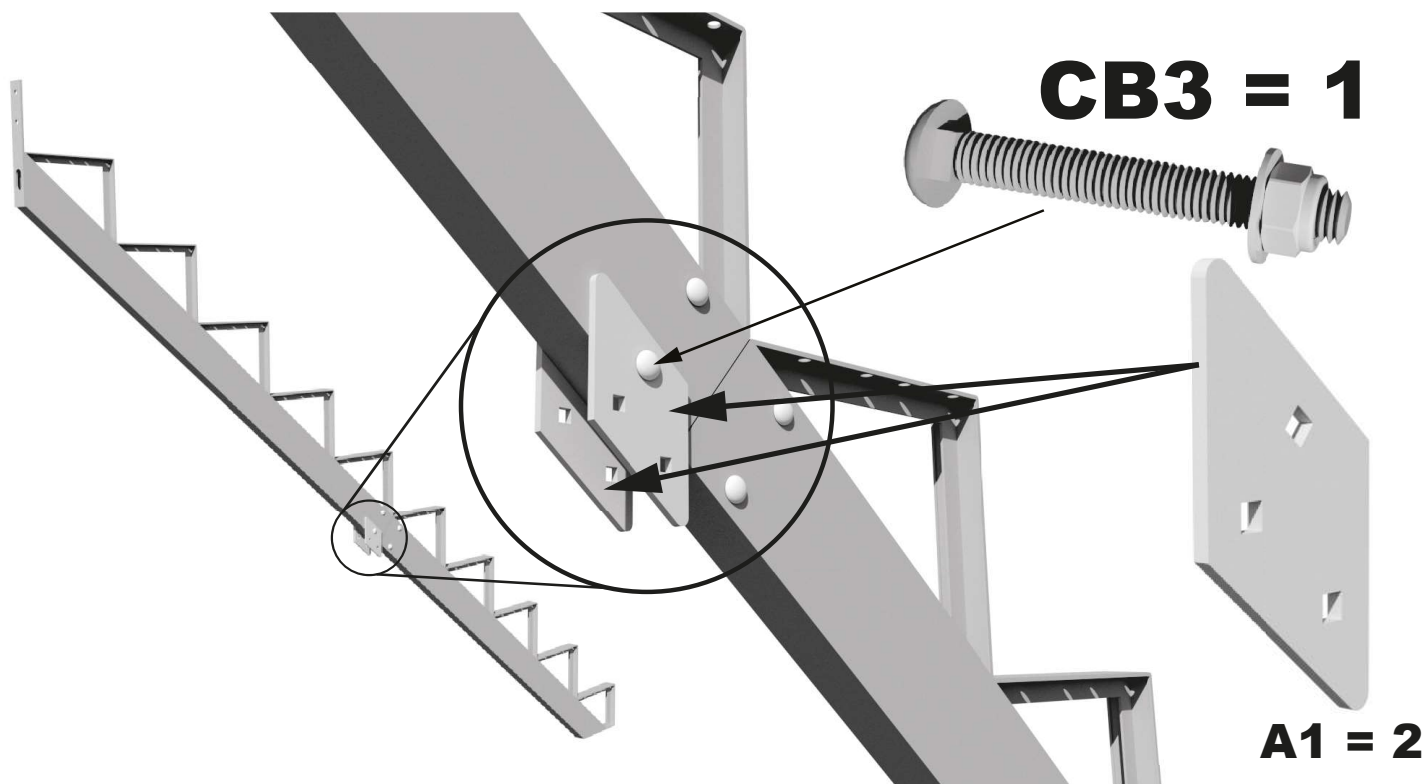

### STEP 4 - FIX STEP AT THE BOTTOM



**WOOD**

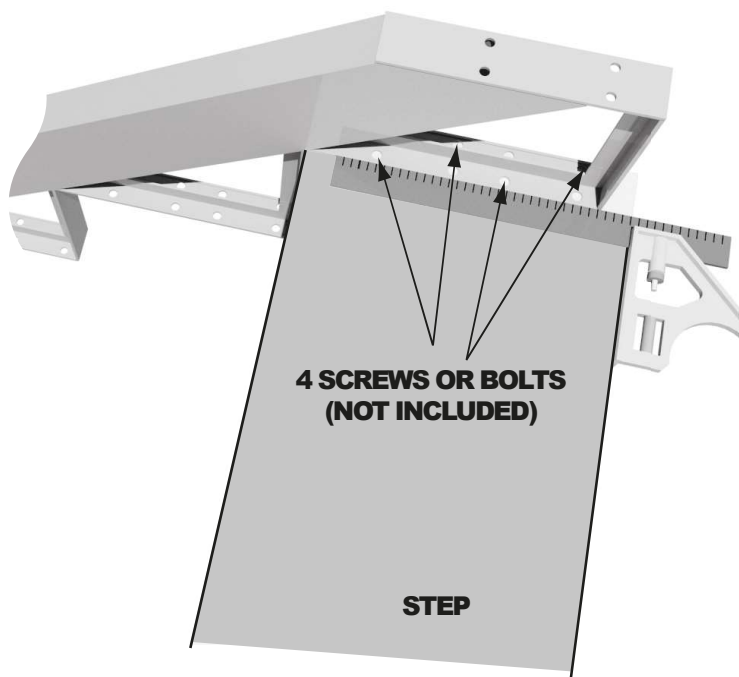

**ALUMINUM**

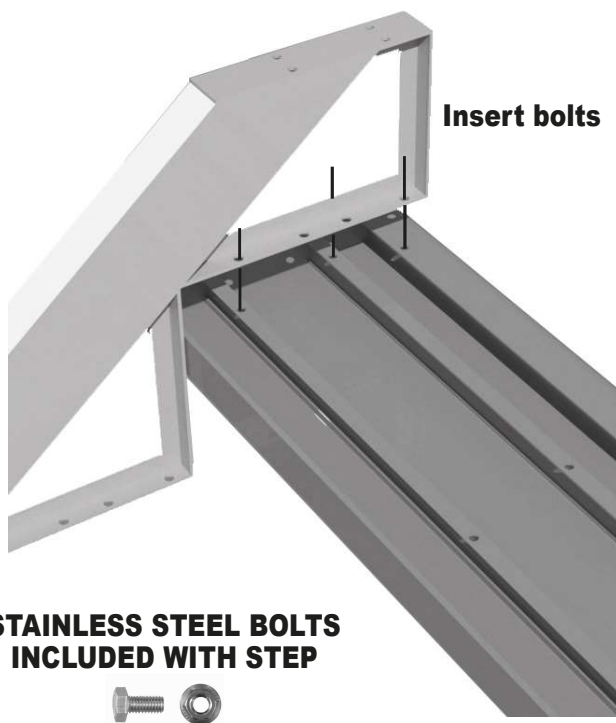

## STEP 5 - FIX STEP IN THE MIDDLE



### WOOD

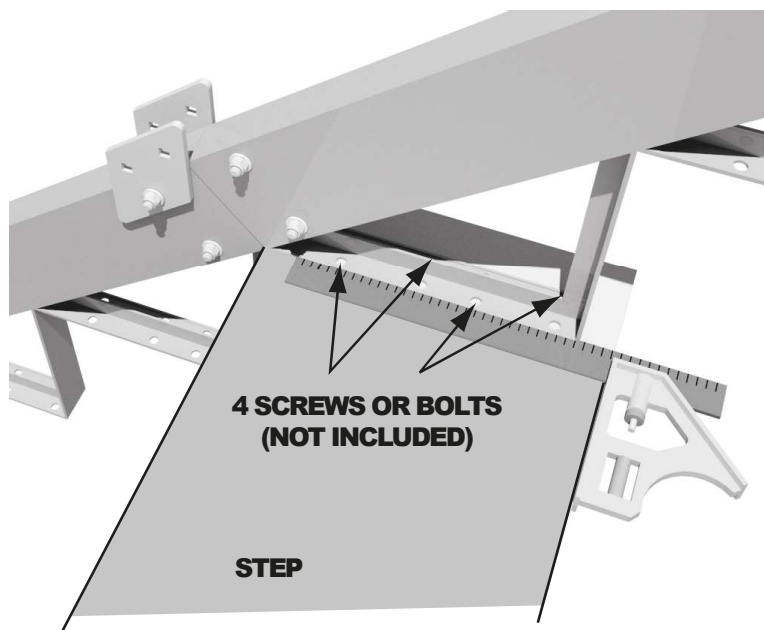

### ALUMINUM

STAINLESS STEEL BOLTS  
INCLUDED WITH STEP

Insert bolts

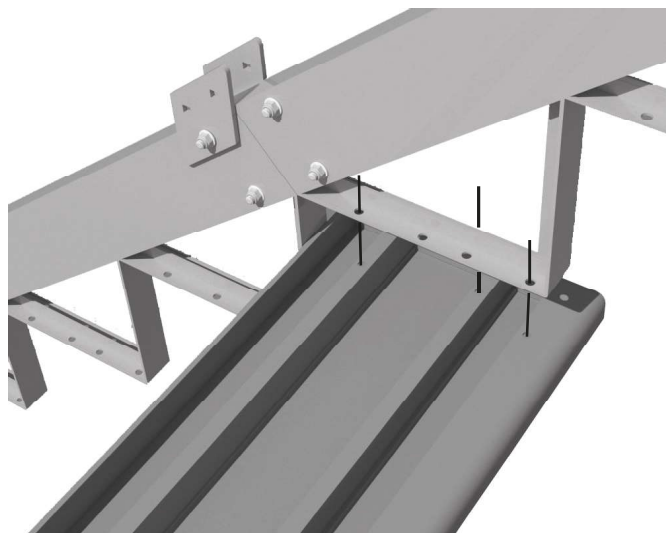

## STEP 6 - FIX STEP AT THE TOP



### WOOD

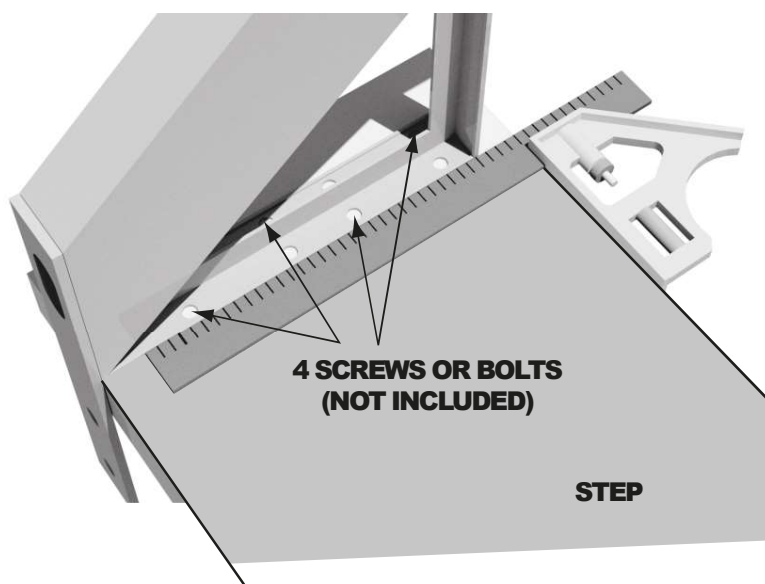

### ALUMINUM

Insert bolts

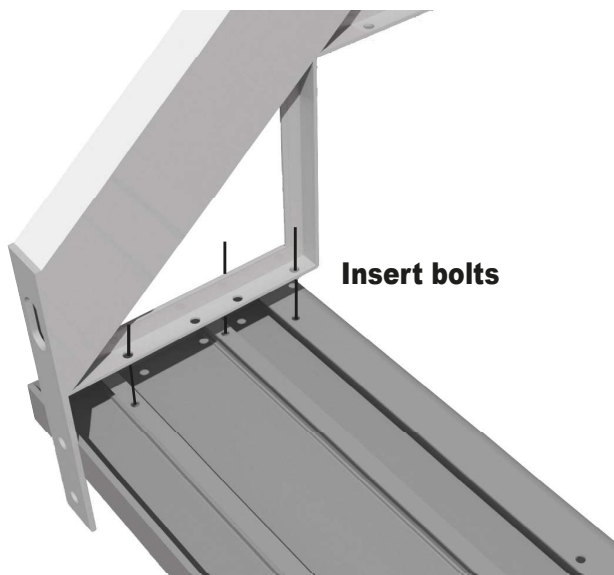

STAINLESS STEEL BOLTS  
INCLUDED WITH STEP





## STEP 7 - DRILL (1/8" HOLES)

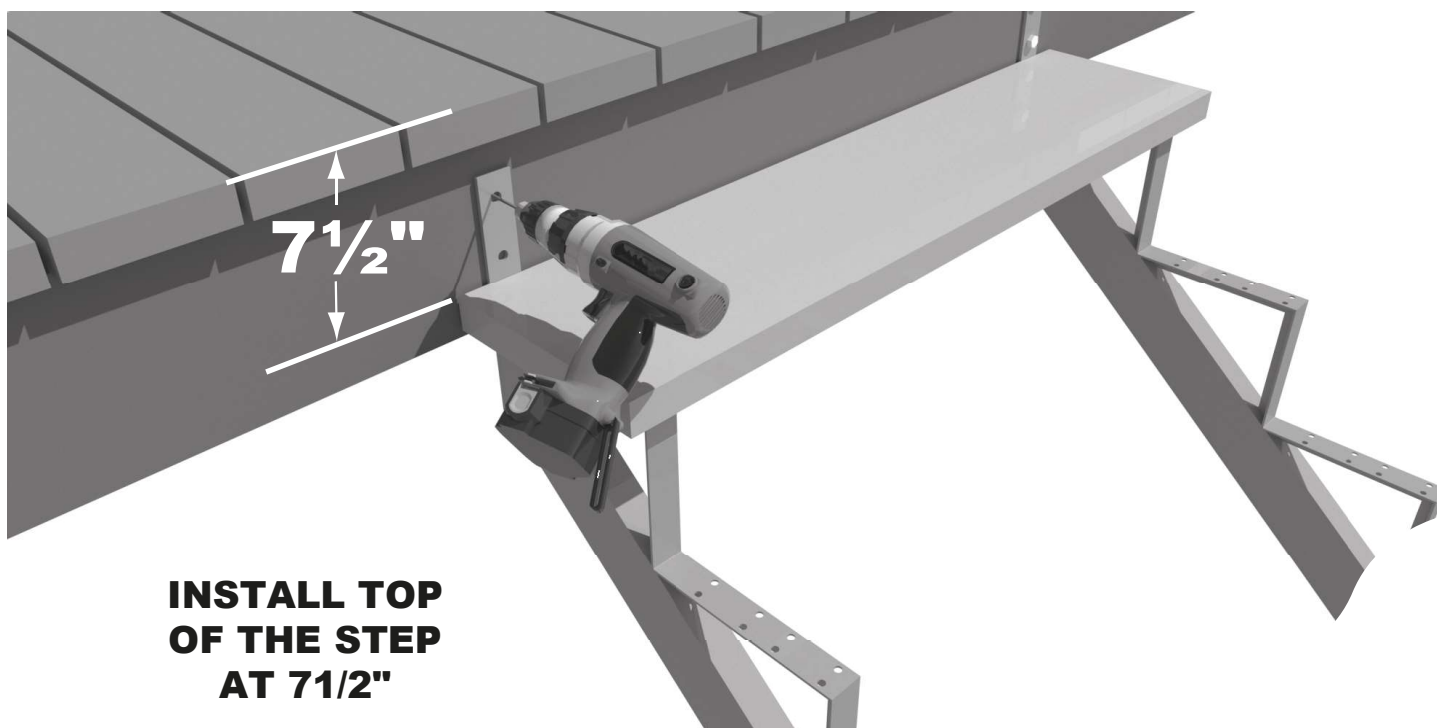

## STEP 8

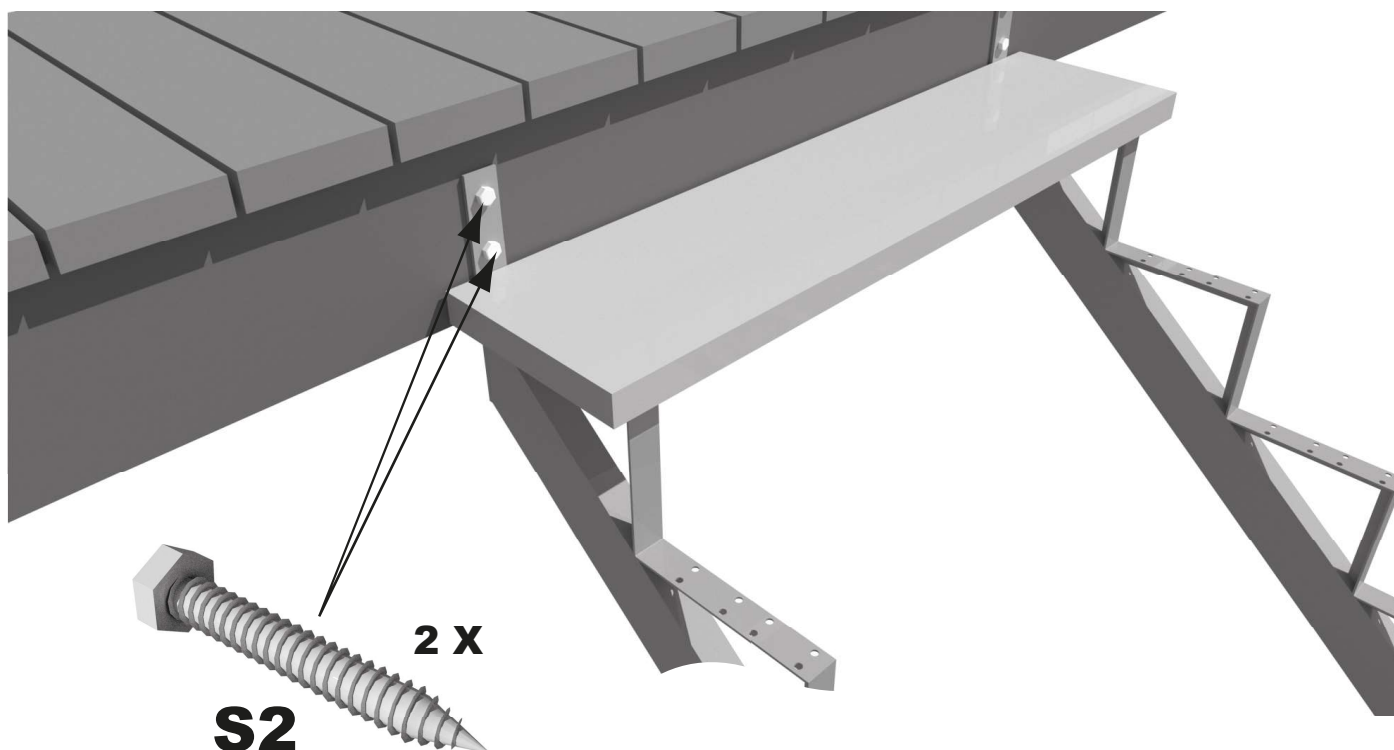

## STEP 9

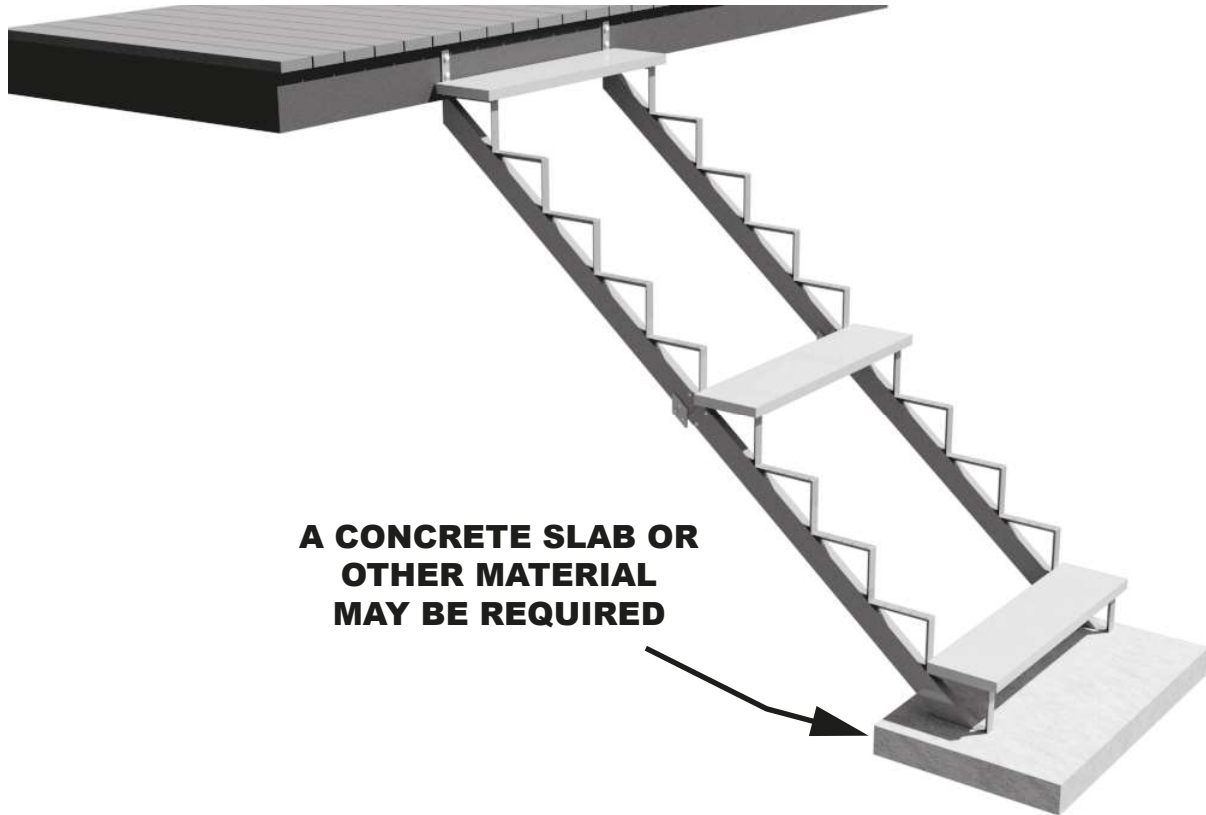

## STEP 10 - INSTALLATION OF SUPPORT POST

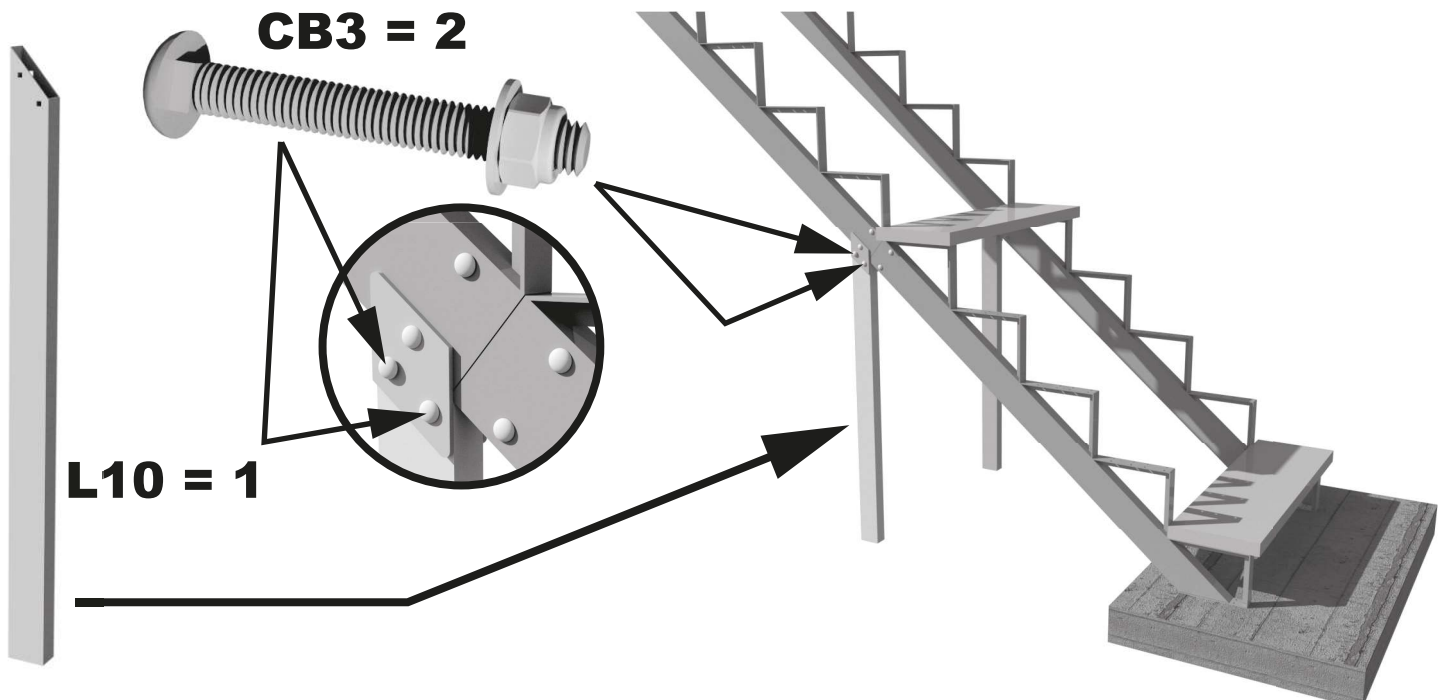



## STEP 11 - INSTALLATION OF SUPPORT POST (CONT'D)



**CUT SUPPORT  
POSTS AT  
DESIRED LENGTH**



**AND REMOVE THE  
THICKNESS OF  
PART A3: 1/4"**

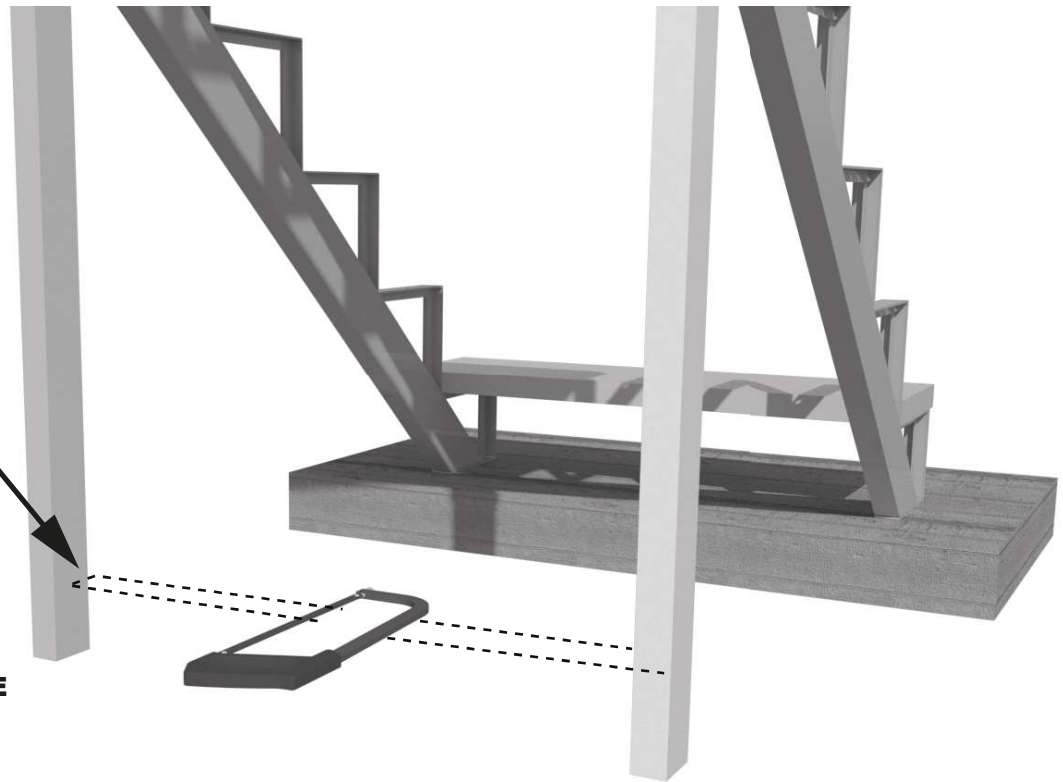

## STEP 12 - POST INSTALLATION (ON CONCRETE SLAB)

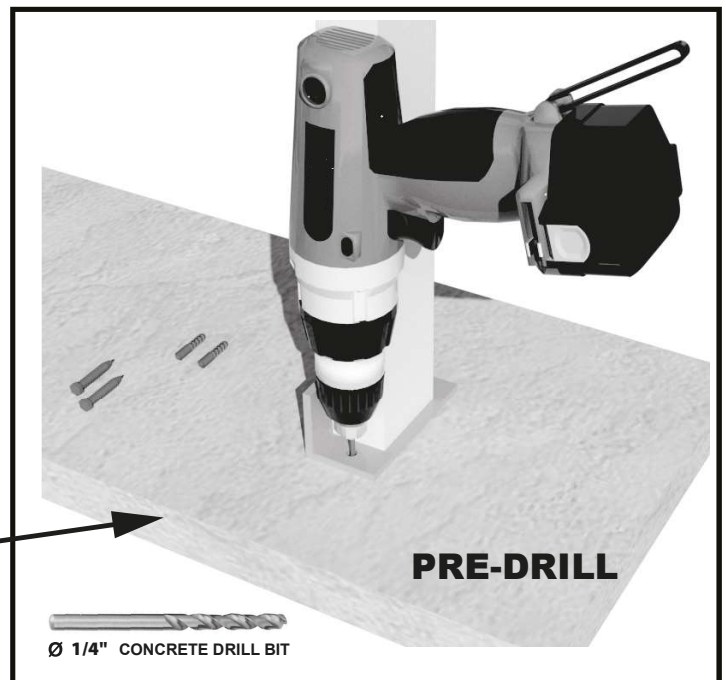
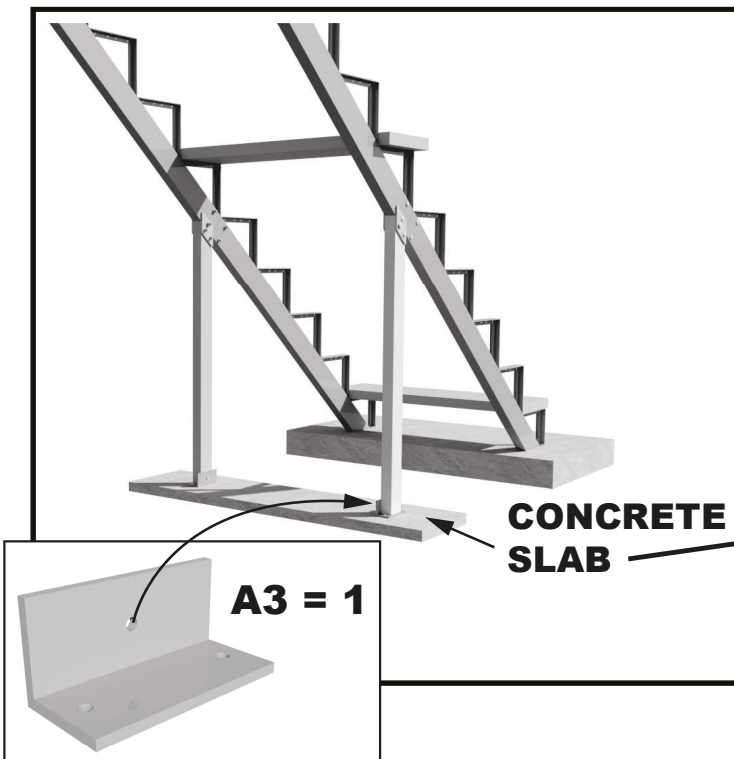

## STEP 13 - POST INSTALLATION (ON CONCRETE SLAB) (CONT'D)

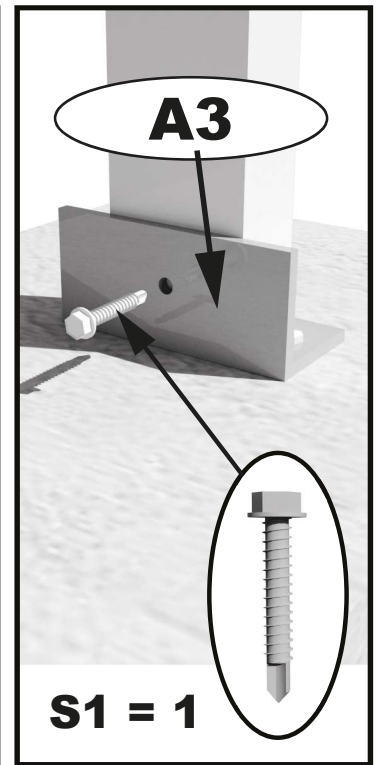
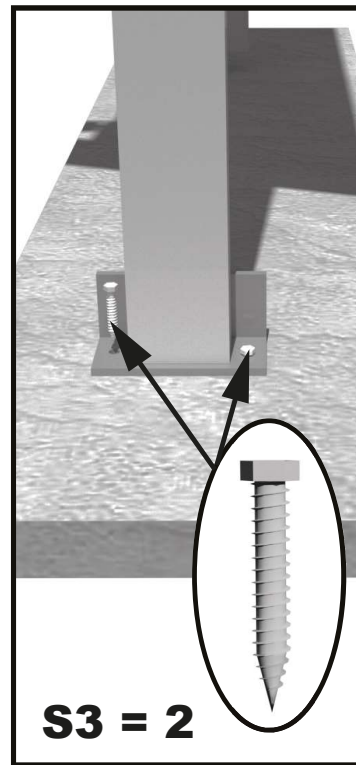
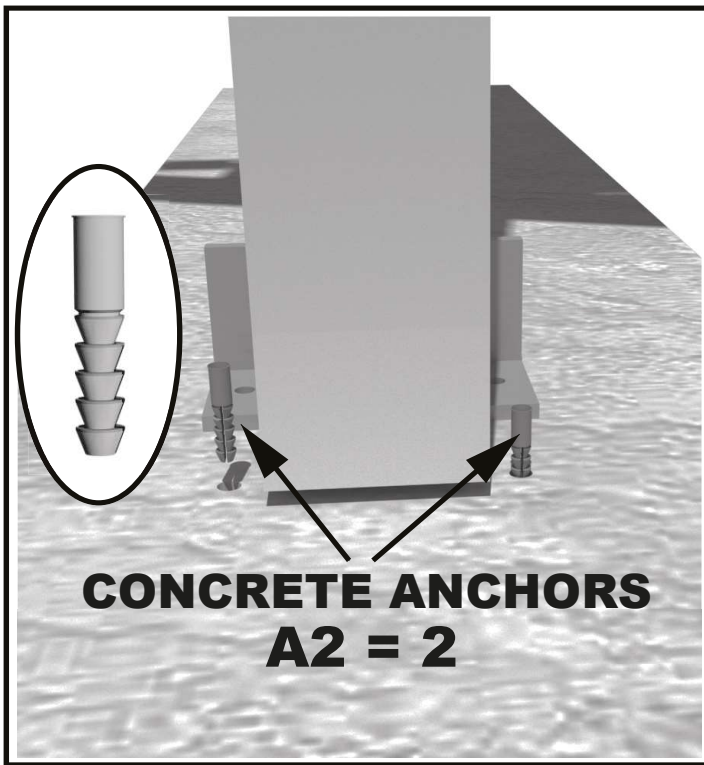

## STEP 14 - INSTALLATION OF BRACES

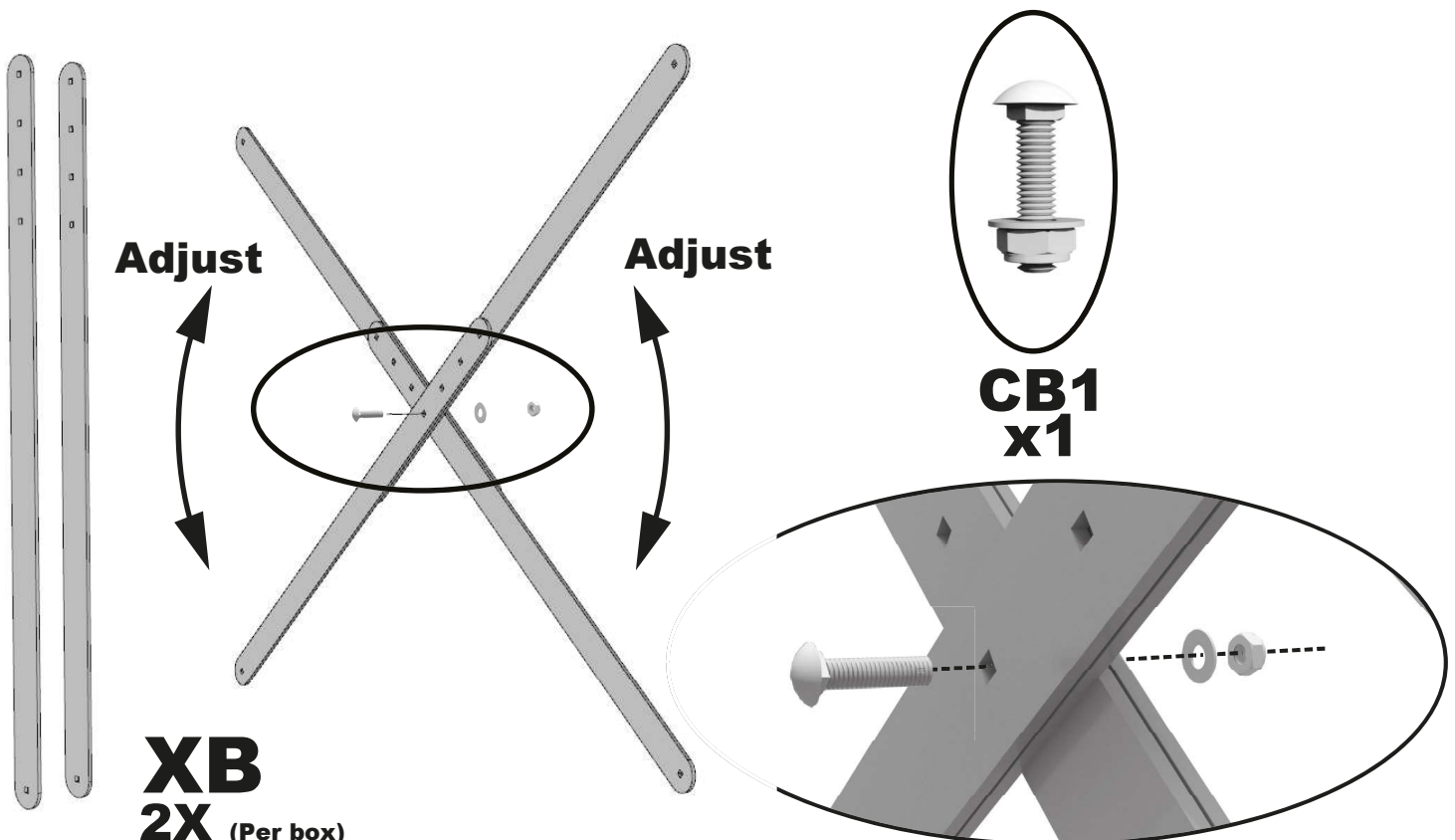

## ÉTAPE 15 - INSTALLATION OF BRACES (CON'D)



Adjust according  
to the height  
of support posts

**XB**  
**2X** (Per box)

**CONCRETE  
SLAB**

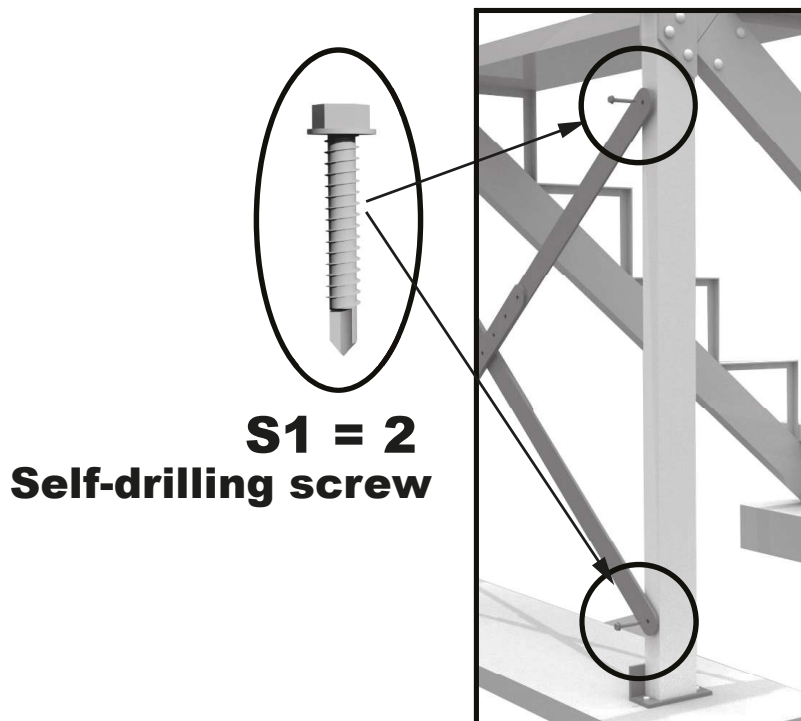

## STEP 16 - INSTALLATION OF OTHER STEPS



**INSTALL THE  
OTHER STEPS**

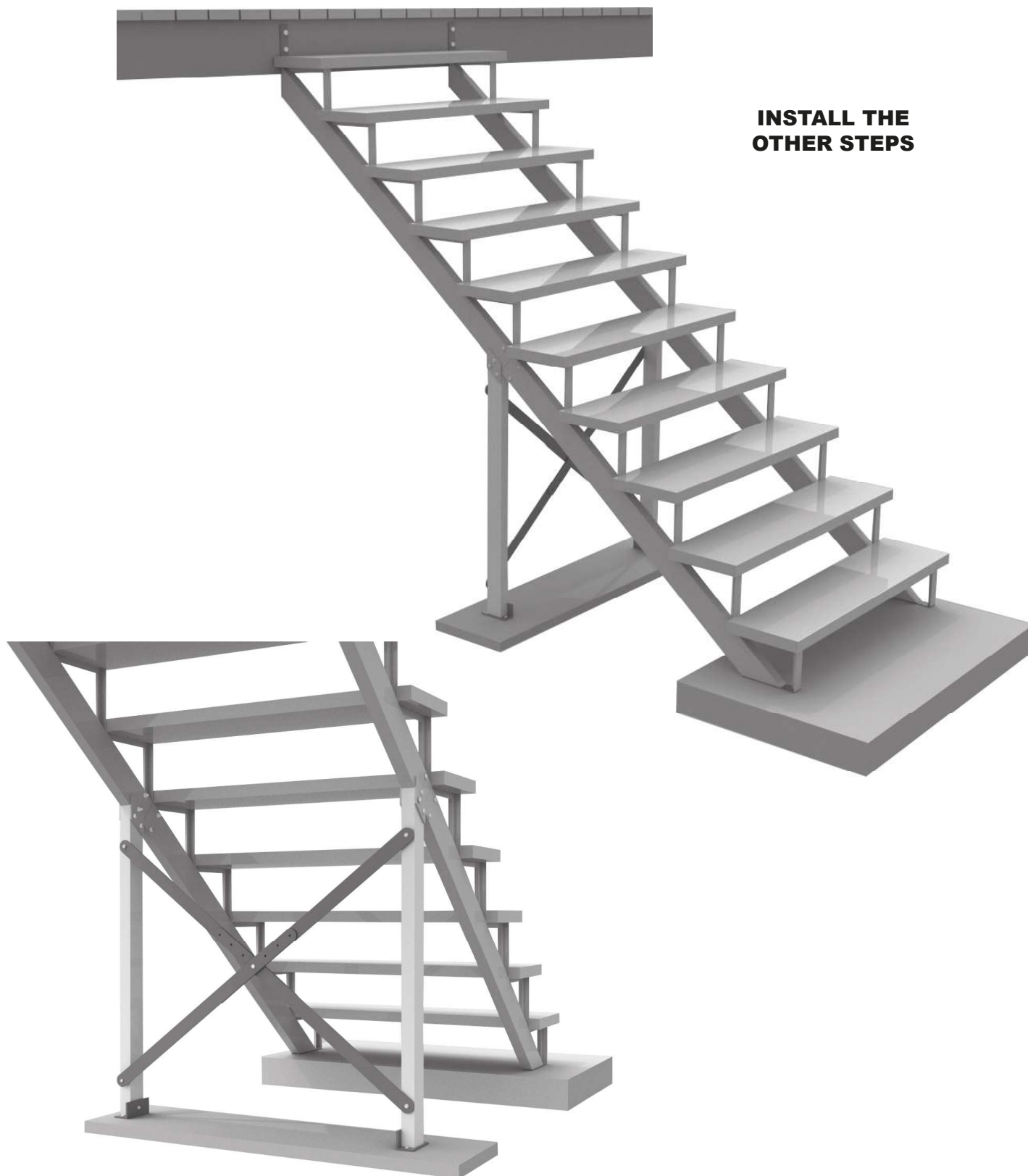





## RATE US!



### **Satisfied with your Pylex product?**

Please let us know by sharing pictures with us at [info@pylex.com](mailto:info@pylex.com)

You can also write a review online  
about your purchase.

*(By sending your image, you agree to give Pylex the right to it in its marketing activities).*

*Thank you !*

---

### **YOU LIKED OUR PRODUCT?**

Visit our website: [www.pylex.com](http://www.pylex.com) to see all our products  
or **scan this QR code** to have access to our catalog!



### **Pylex Guarantee Certificate**



Follow us on:

