

Here is the most  
up-to-date version  
of the installation  
**VIDEO**



Here is the most  
up-to-date version  
of the installation  
**GUIDE**



## **INSTALLATION GUIDE**

# **DECK SUNBLIND SYSTEM - BLACK**

**# 11060**



### **Got a question? - Contact us:**

First contact our friendly customer service team for assistance.

Email: [info@pylex.com](mailto:info@pylex.com) or phone: 1-800-264-1881

Monday to Friday: 8:30 am to 4:30 pm (EST)

Replacement o damaged or missing parts will be shipped promptly.

Rev.: 42-1203



**DECK AND FENCE HARDWARE**  
**WWW.PYLEX.COM / 1 800-264-1881**

## PARTS LIST



**A** 10X



**E** 66X



**F** 33X



**B** 1X

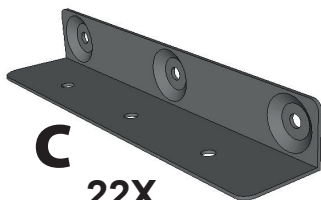

**C** 22X

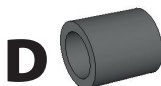

**D** 22X

## TOOLS REQUIRED



Ø 1/16"

#2



for a 2" x 6" / 6" x 6"  
structure



### NUMBER OF BOARDS

### REQUIRED OPENING

REQUIRES

**1** BOX

2

10"

254 mm

3

14-<sup>5</sup>/<sub>16</sub>"

364 mm

4

18-<sup>11</sup>/<sub>16</sub>"

474 mm

5

23"

584 mm

6

27-<sup>5</sup>/<sub>16</sub>"

694 mm

7

31-<sup>11</sup>/<sub>16</sub>"

804 mm

8

36"

914 mm

9

40-<sup>5</sup>/<sub>16</sub>"

1024 mm

10

44-<sup>5</sup>/<sub>8</sub>"

1134 mm

11

49"

1244 mm

REQUIRES

**2** BOXES

12

53-<sup>5</sup>/<sub>16</sub>"

1354 mm

13

57-<sup>5</sup>/<sub>8</sub>"

1464 mm

14

62"

1574 mm

15

66-<sup>5</sup>/<sub>16</sub>"

1684 mm

16

70-<sup>5</sup>/<sub>8</sub>"

1794 mm

17

75"

1904 mm

18

79-<sup>5</sup>/<sub>16</sub>"

2014 mm

## STEP 1 - MEASUREMENTS



**B 1X**

FOR INSTALLATION ON

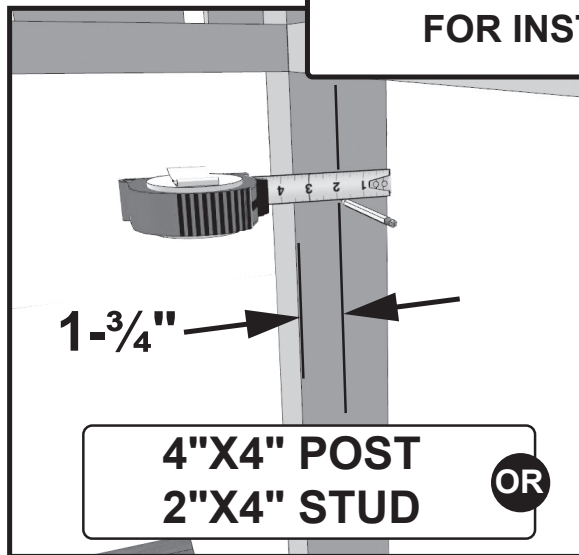

Go to page 4

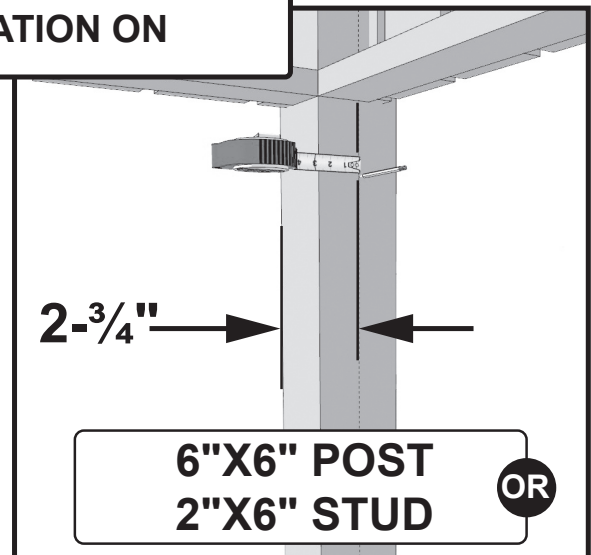

Go to page 11

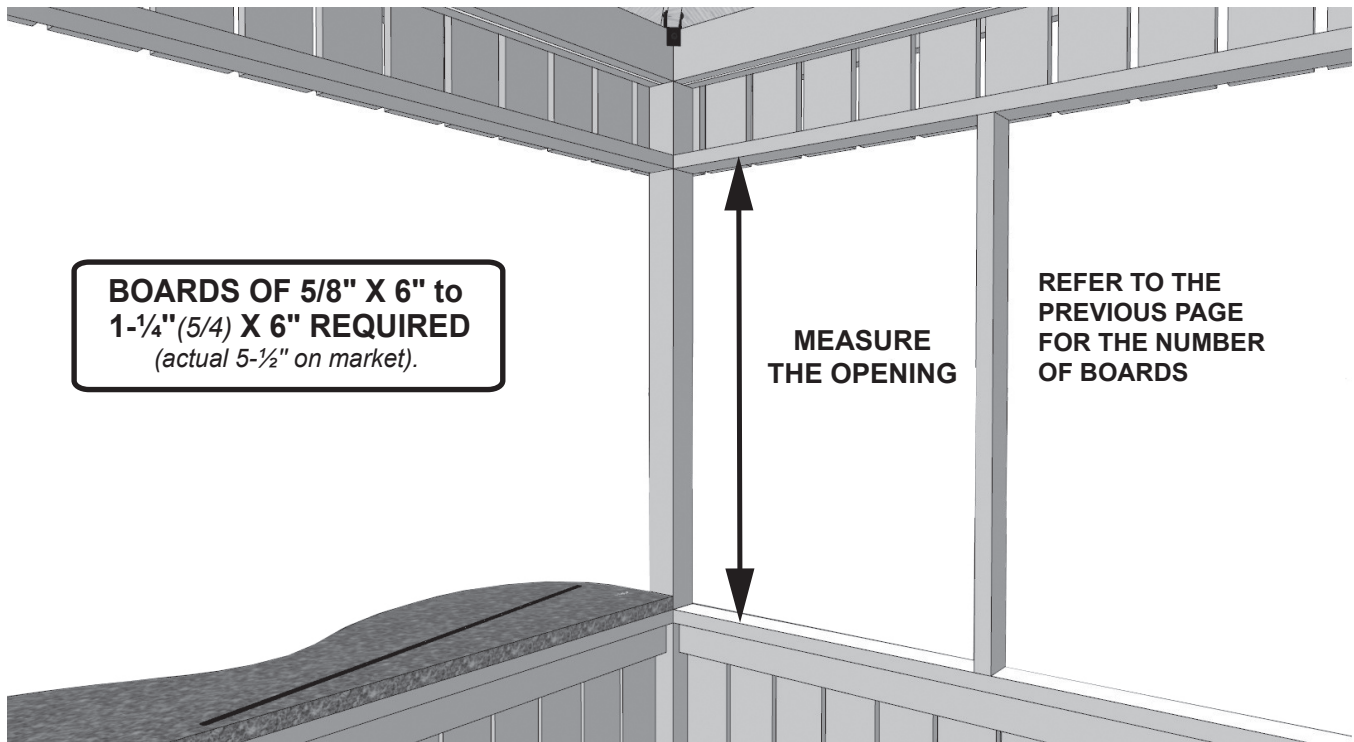

## STEP 2 - HOLE POSITION STRIP

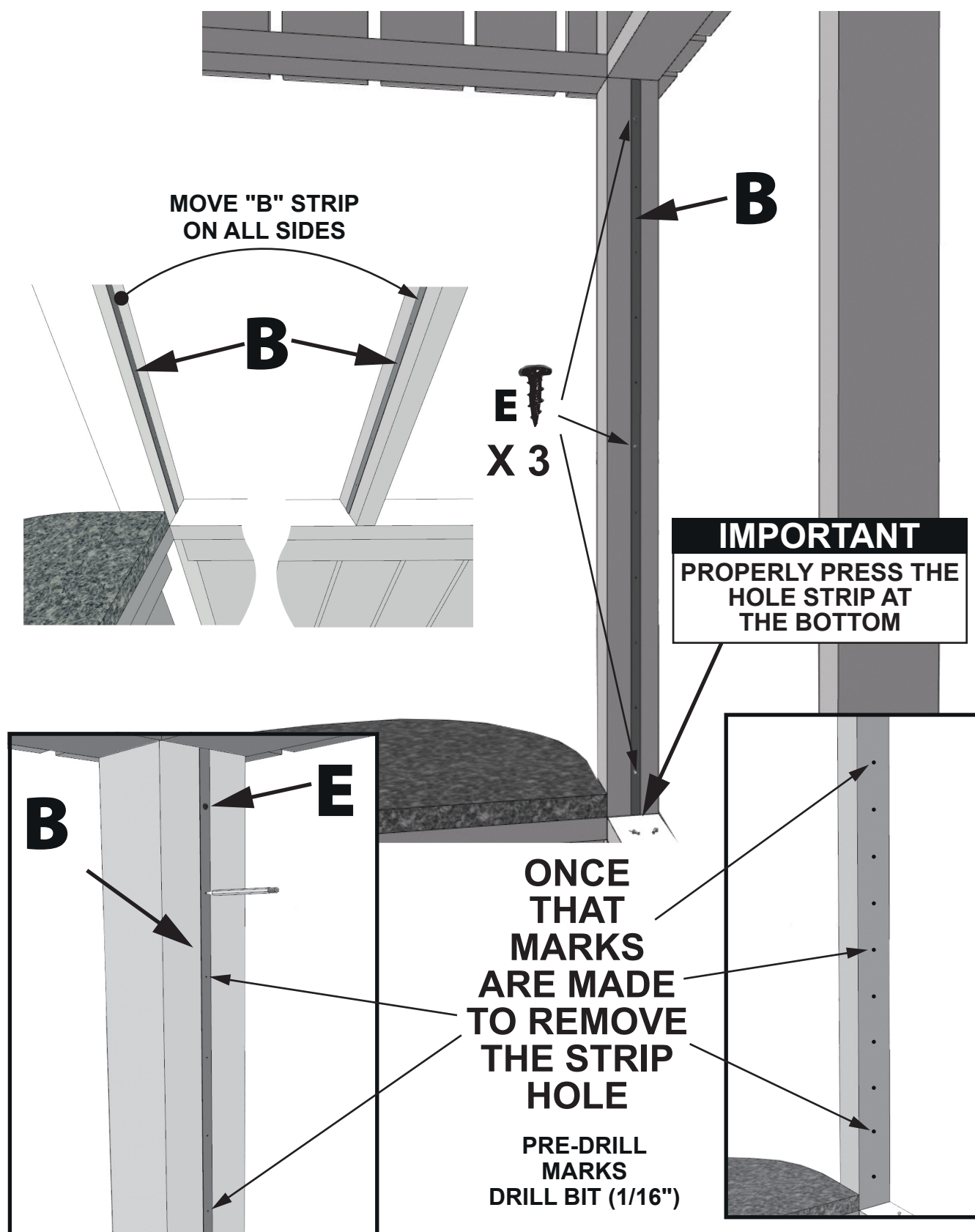

### STEP 3 - INSTALLING "C" AND "D" PARTS

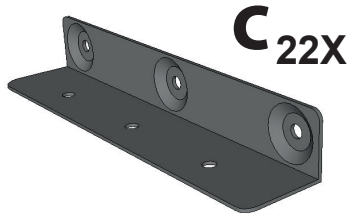

**INSTALL ON  
EACH MARK**

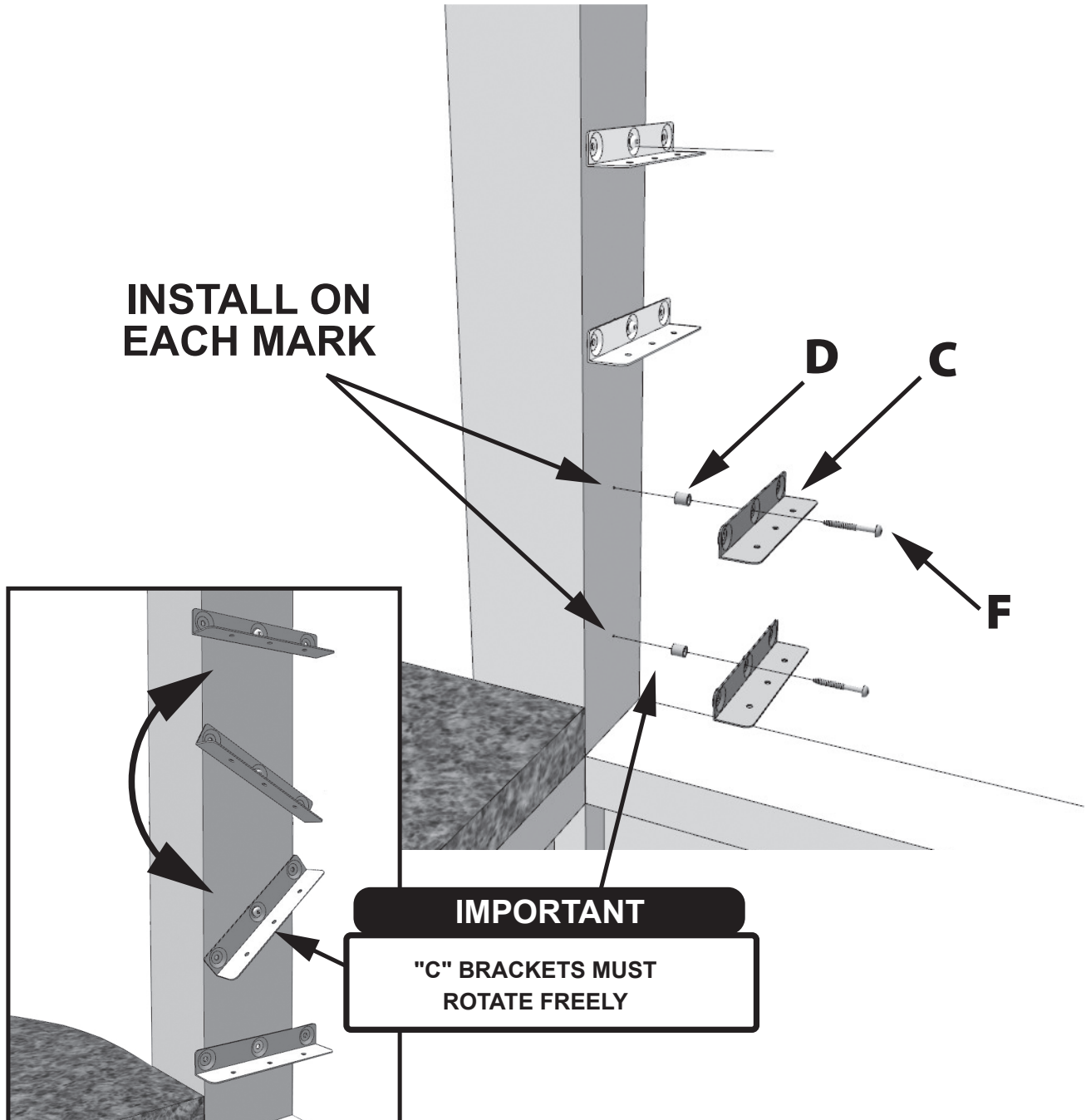

**IMPORTANT**

**"C" BRACKETS MUST  
ROTATE FREELY**

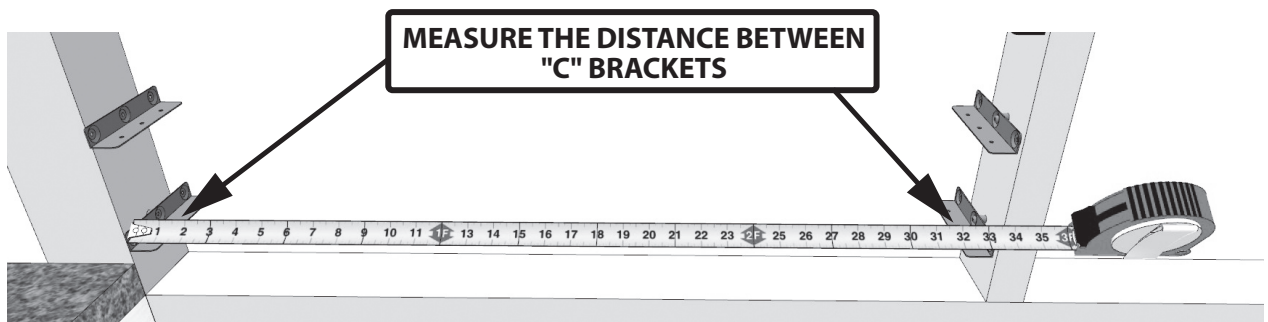
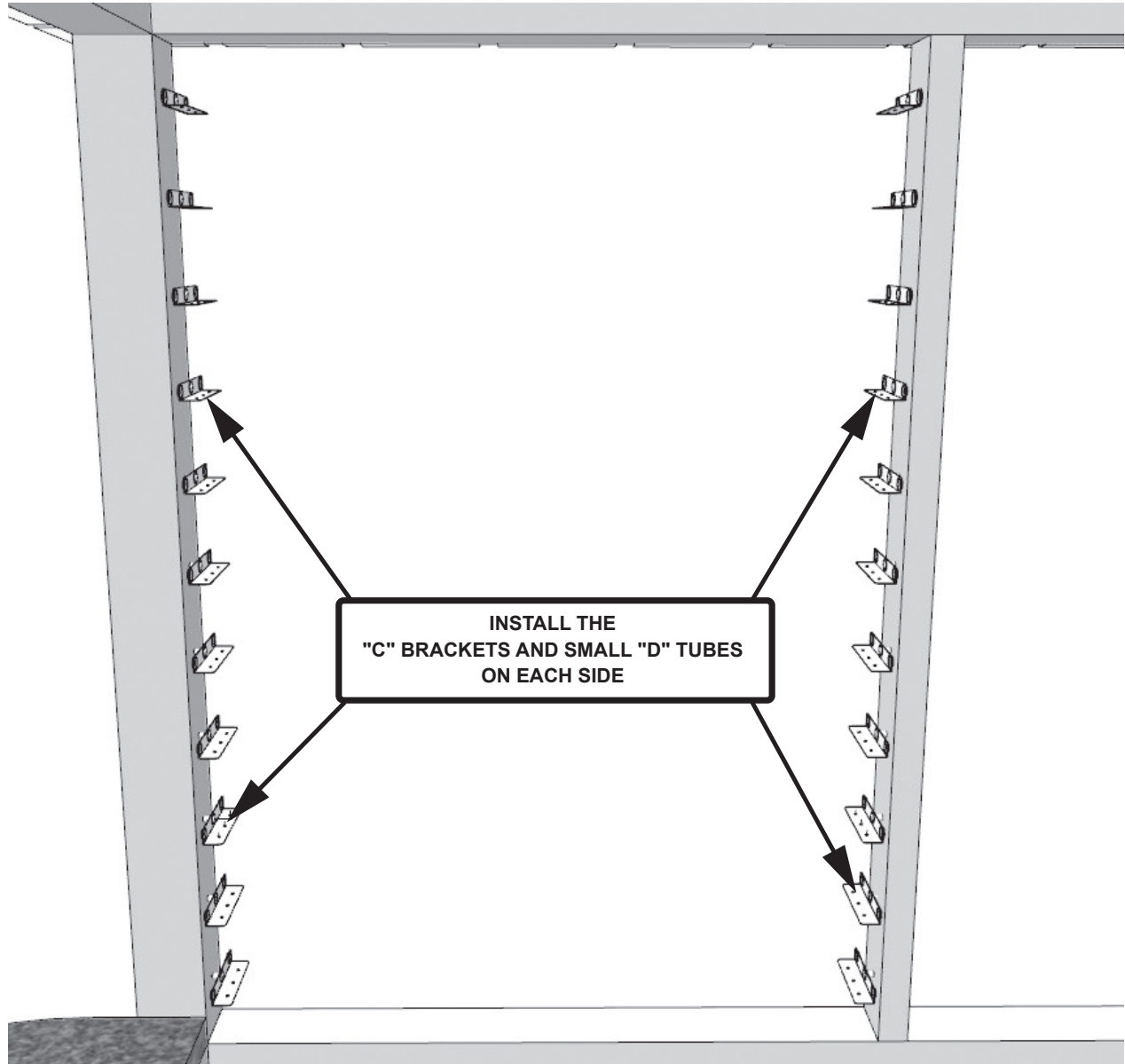

**(Repeat this step for each board, it is possible that the boards are not all exactly the same length)**

## STEP 4 - INSTALLING THE BOARDS

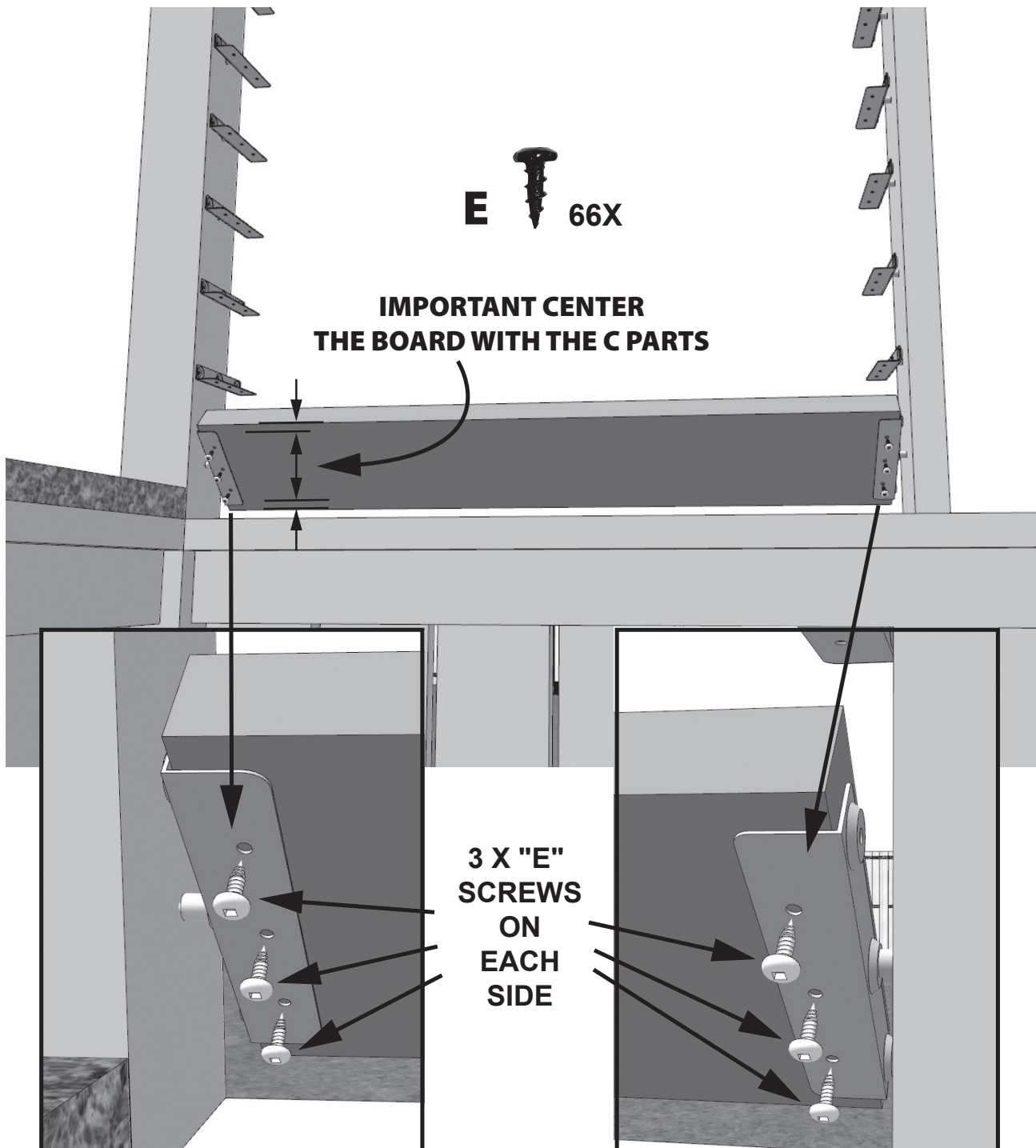

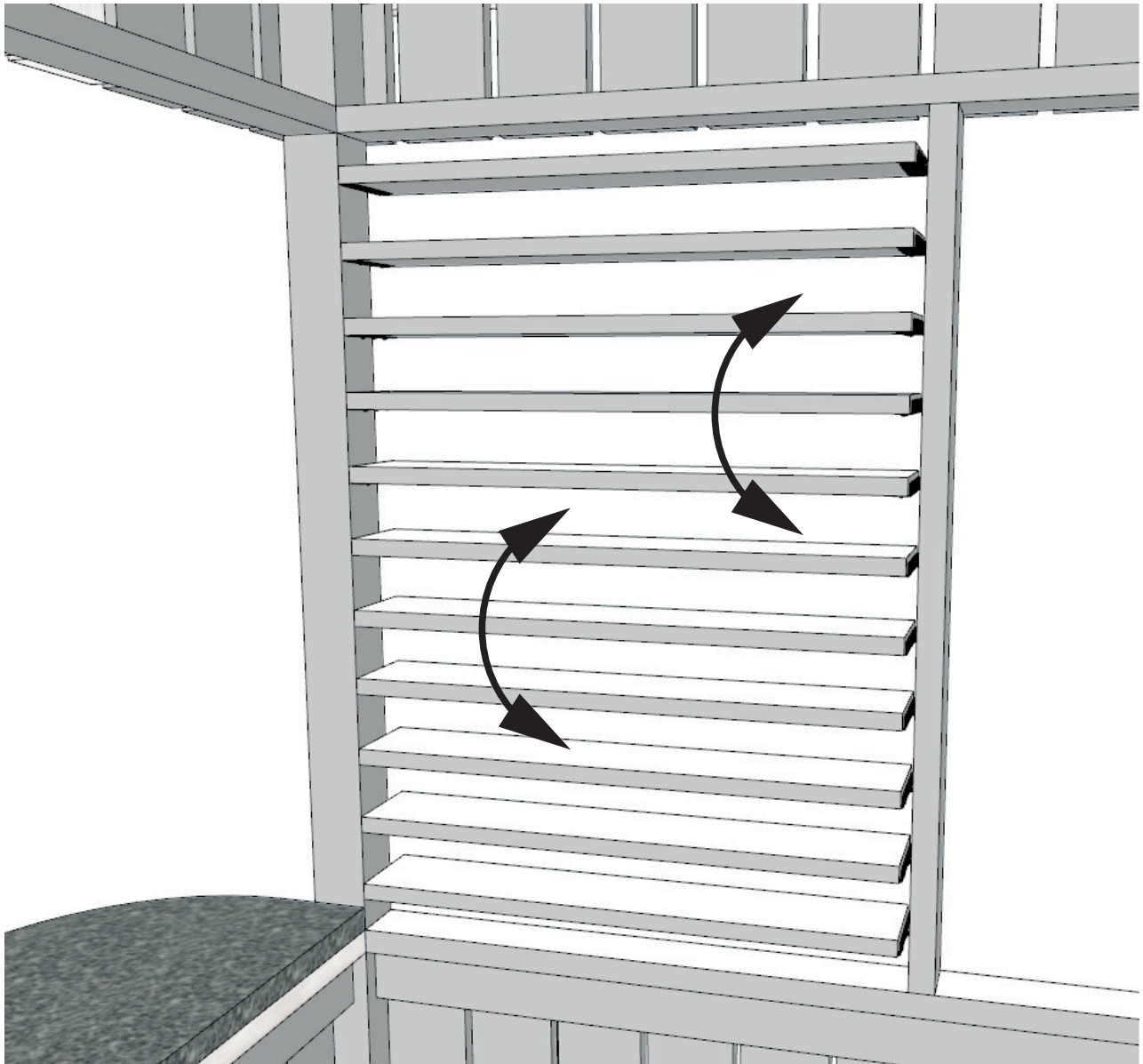

**IMPORTANT**

**BOARDS MUST  
ROTATE FREELY**

## STEP 5 - INSTALLING "A" PARTS

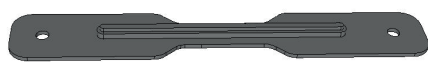

**A10X**



**F**

**11X**

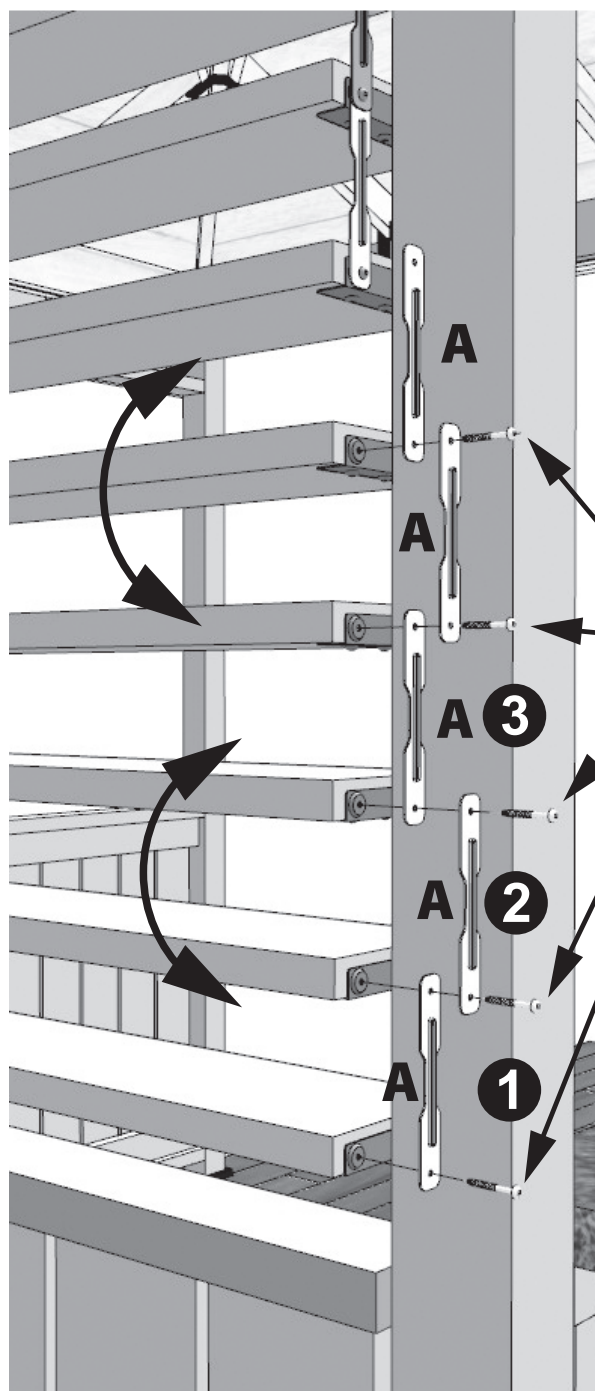

**IMPORTANT**

**BOARDS MUST  
ROTATE FREELY**

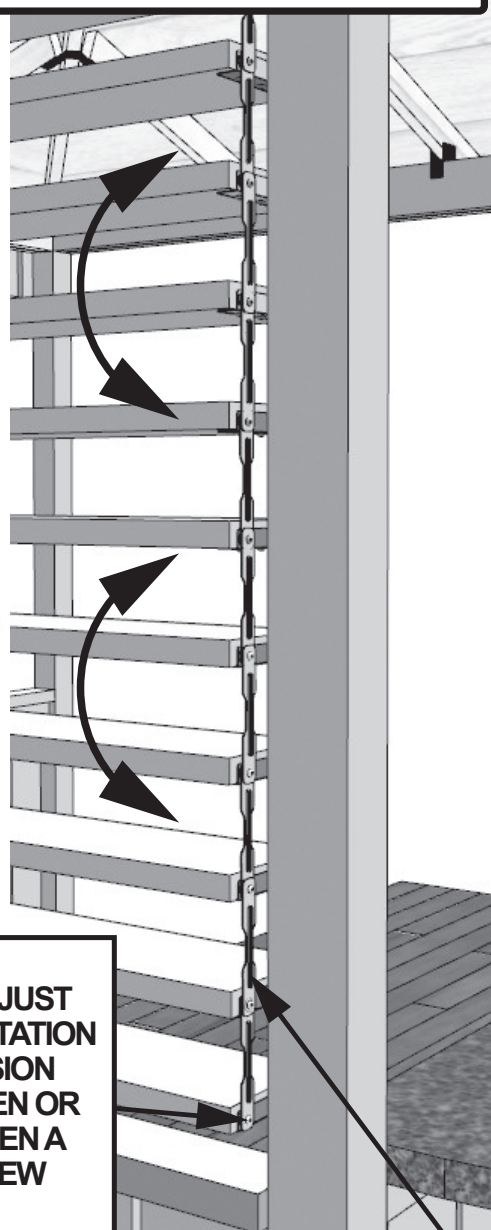

TO ADJUST  
THE ROTATION  
TENSION  
TIGHTEN OR  
LOOSEN A  
SCREW

**"A" PARTS ONLY FIT ON ONE SIDE.**

## STEP 6 - INSTALLATION ON A 4" X 4" (CORNER)

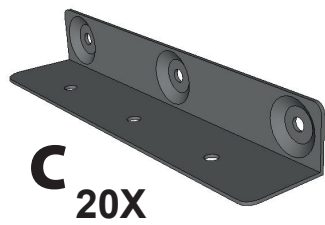

### 4" X 4" POST ONLY

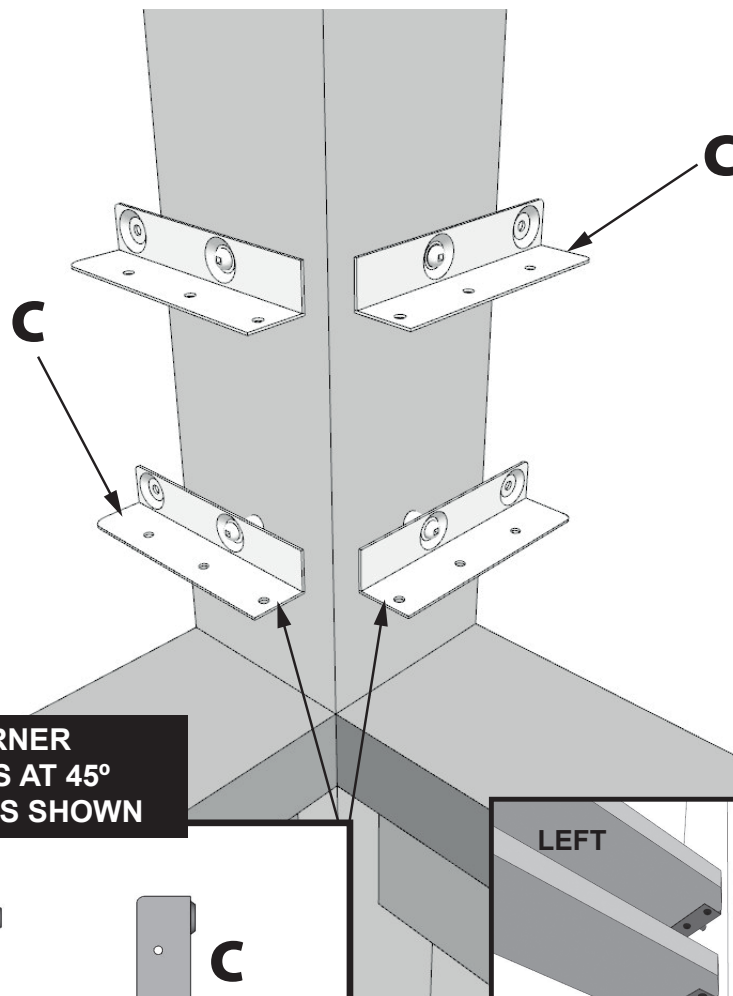

**CUT THE CORNER  
OF THE BOARDS AT 45°  
AND BRACKETS AS SHOWN**

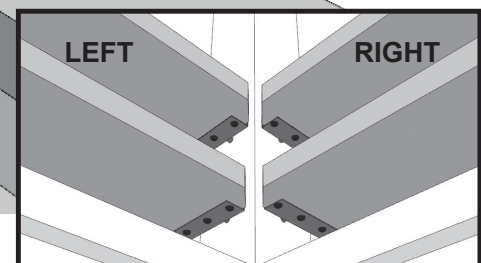
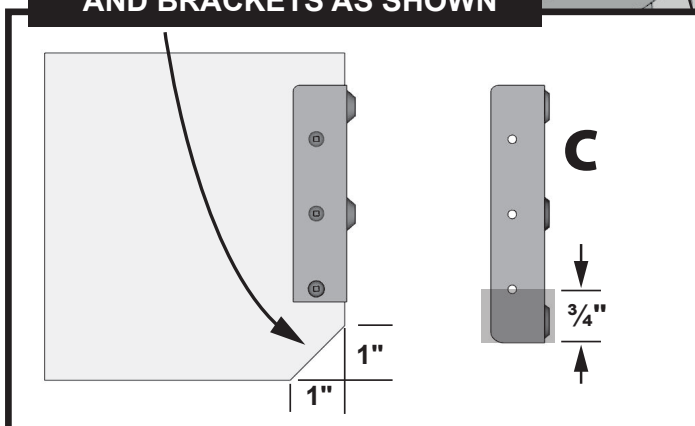

**CUT THE  
3/4" METAL BRACKETS**

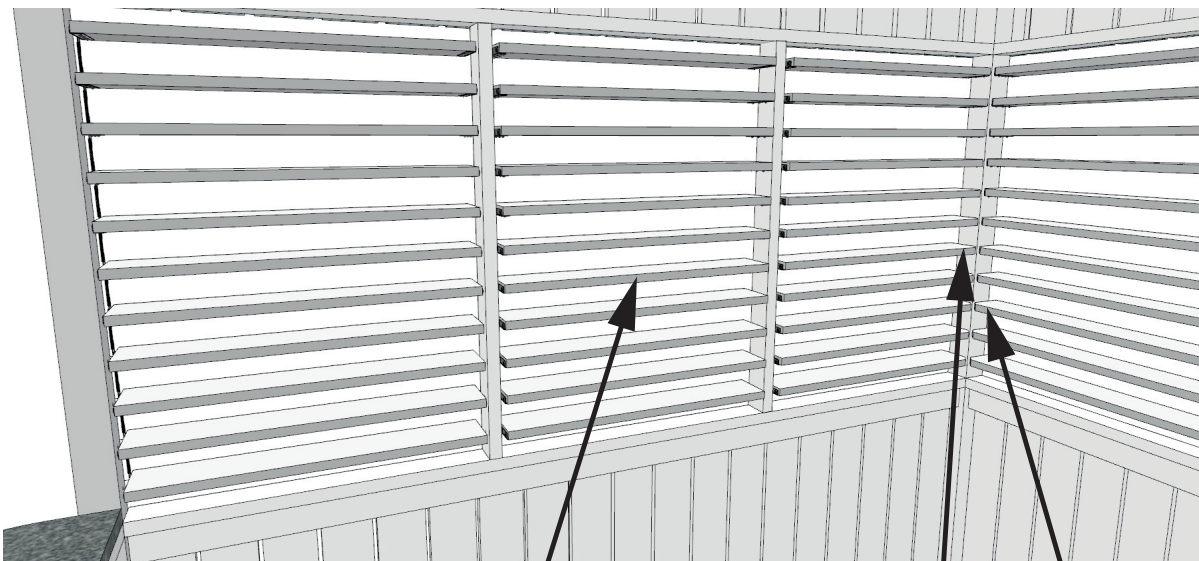

**INSTALL OF OTHERS  
SECTIONS  
(Steps de 1 à 5)**

**CORNERS CUTTING**

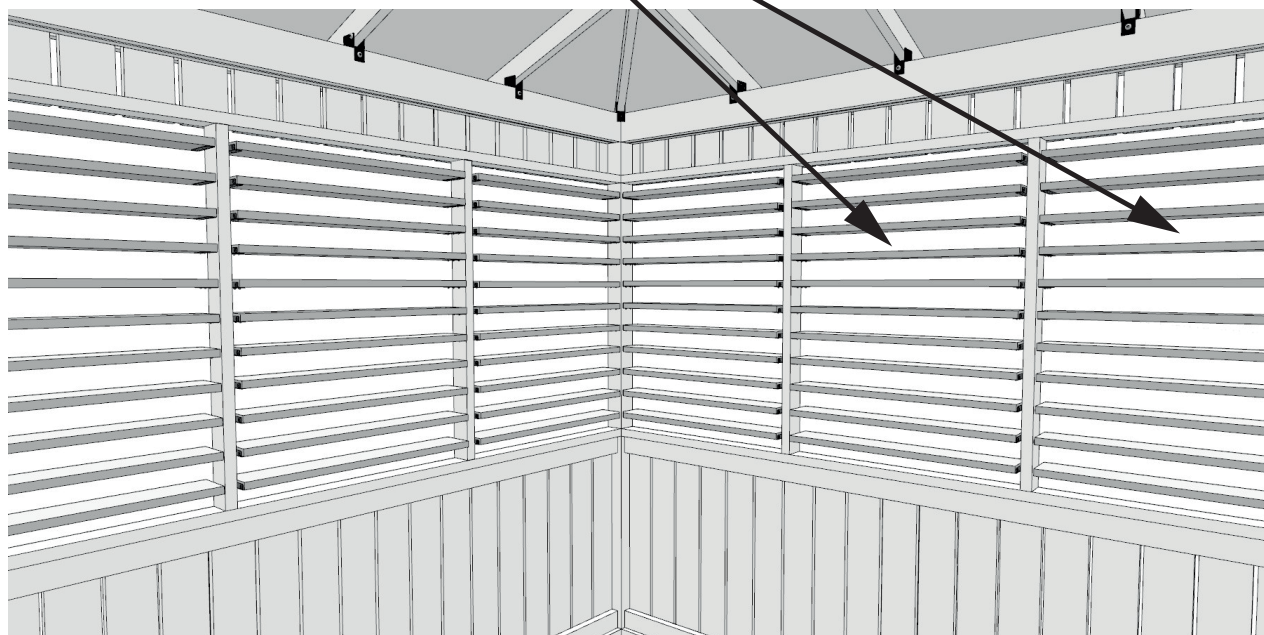

## STEP 1 - INSTALLATION ON A 6" X 6"

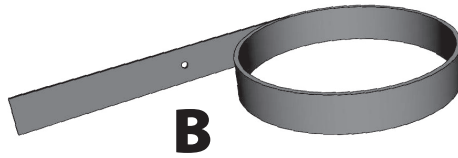

### 6" X 6" POST

**B**



**E**



**MARK EACH HOLE**

## STEP 2 - RIVET INSTALLATION

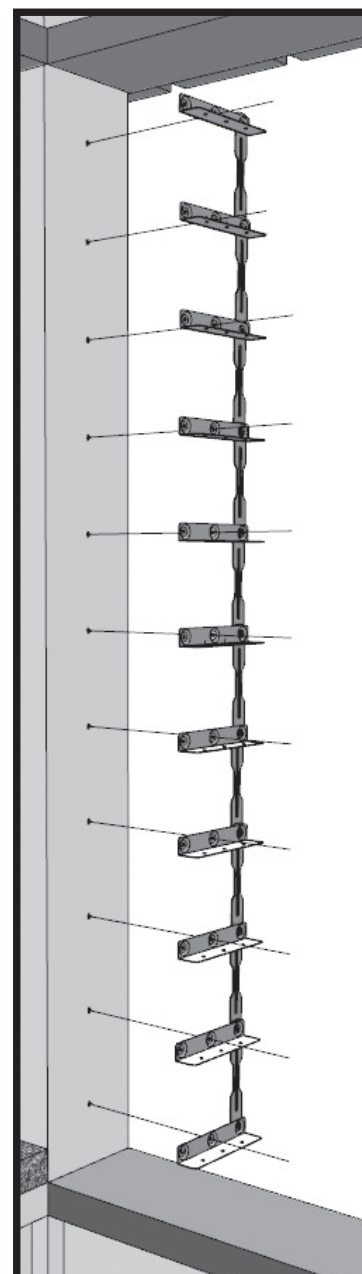
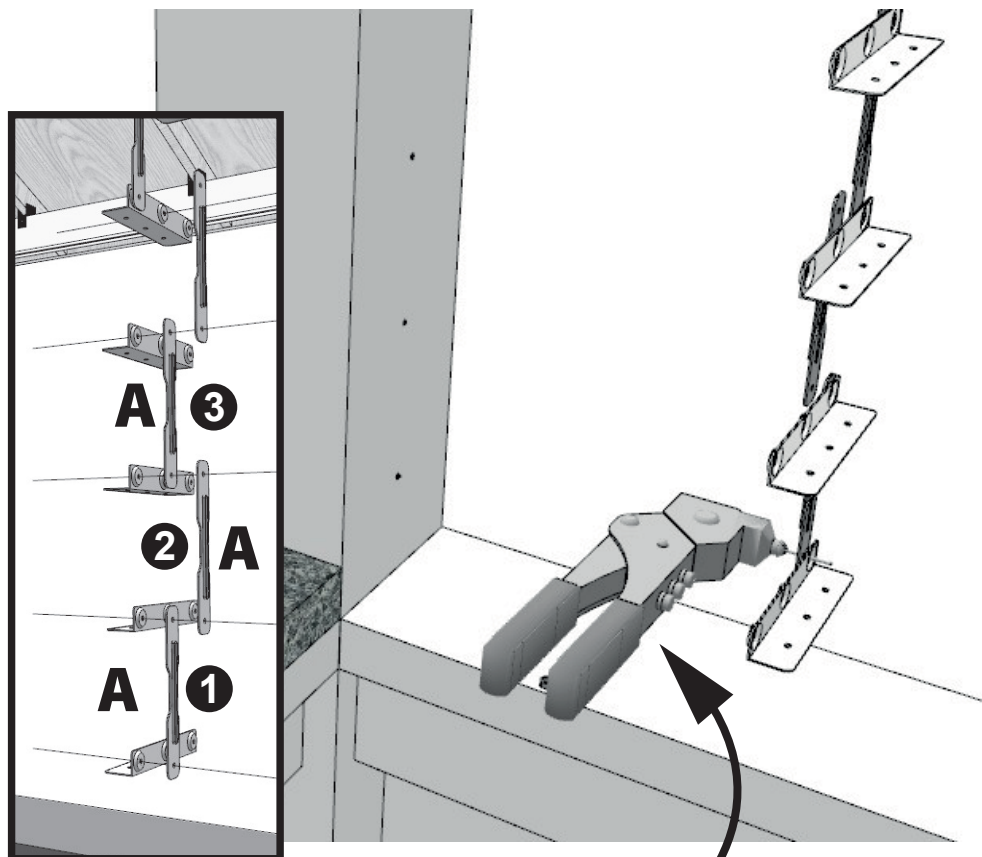
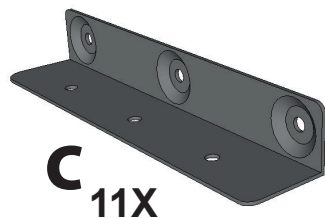

**RIVET GUN**

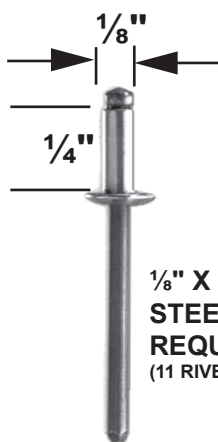

**ASSEMBLE ALL  
"A" AND "C" PARTS  
AS SHOWN  
WITH RIVETS  
ON ONE SIDE ONLY**

**1/8" X 1/4"**  
**STEEL RIVETS ARE  
REQUIRED**  
(11 RIVETS - NOT INCLUDED)

## STEP 3 - NEXT

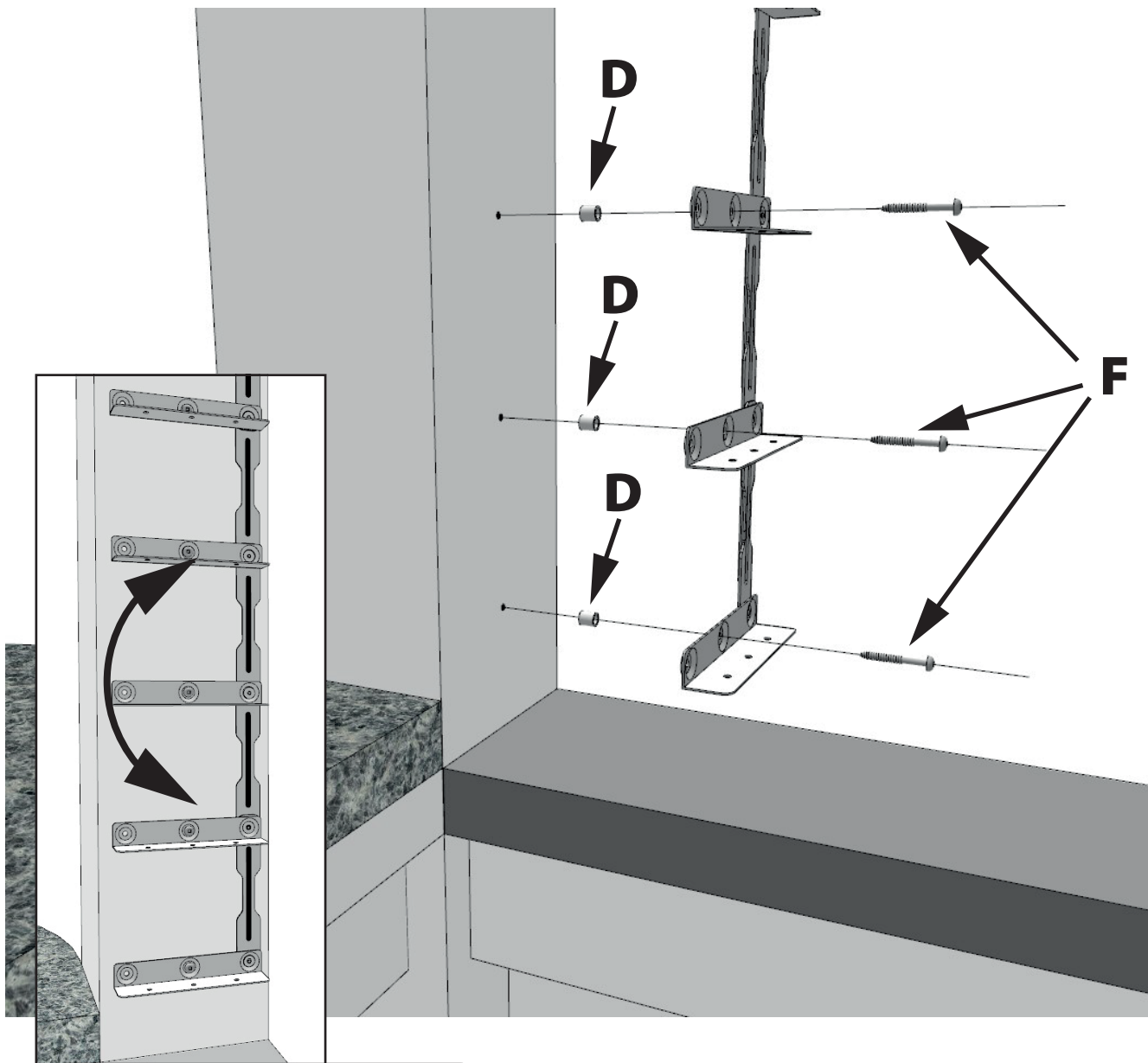

### IMPORTANT

"C" BRACKETS MUST  
ROTATE FREELY

## STEP 4 - INSTALLATION THE BOARDS

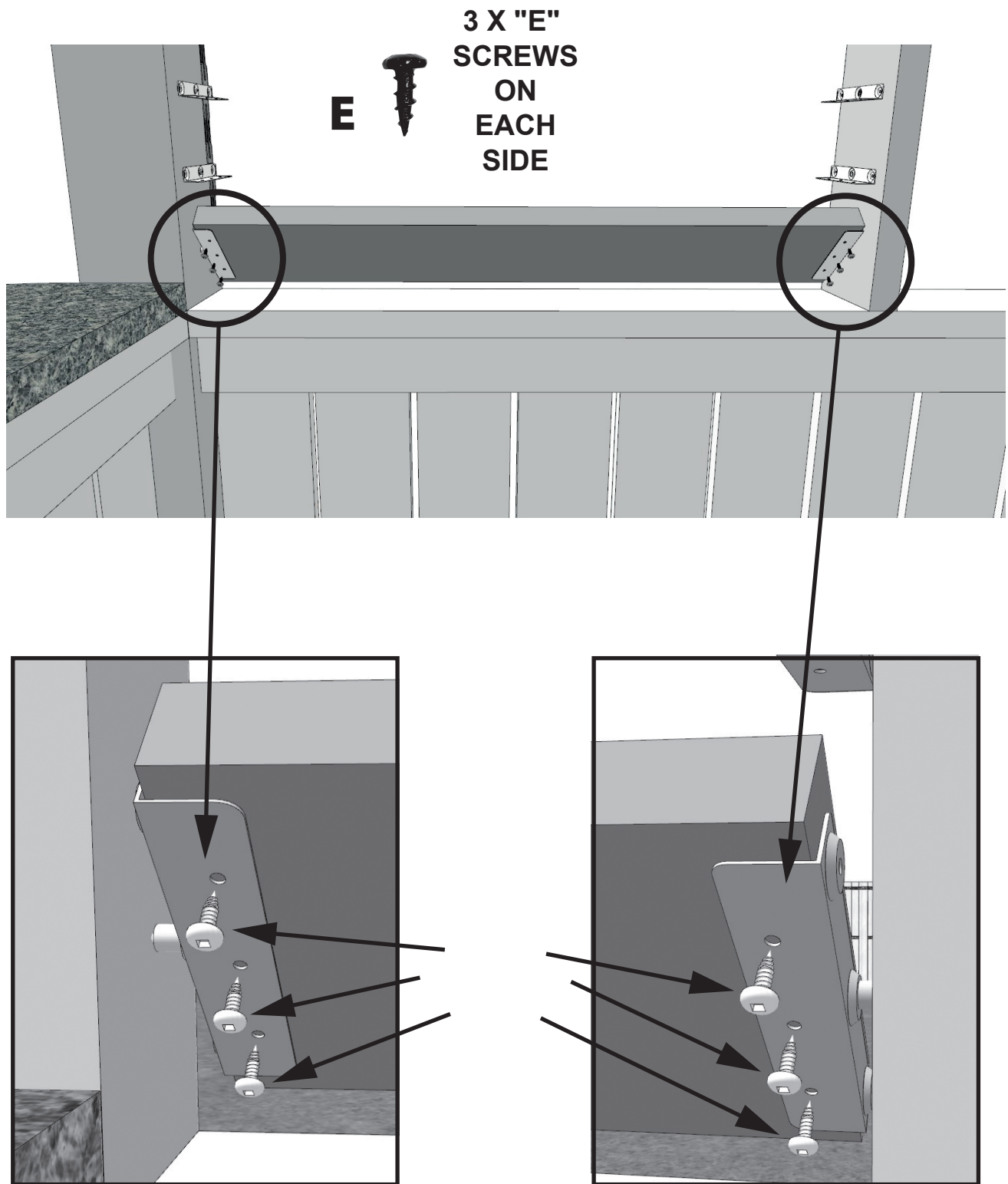

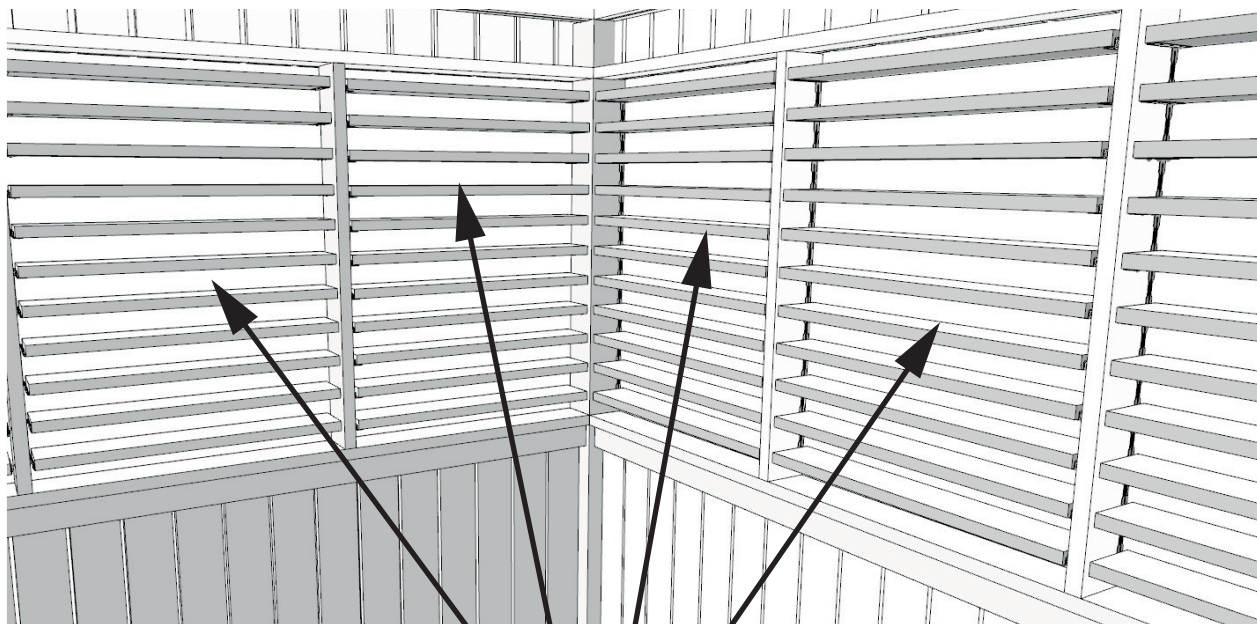

**INSTALL OF OTHERS  
SECTIONS  
(Steps de 1 à 5)**

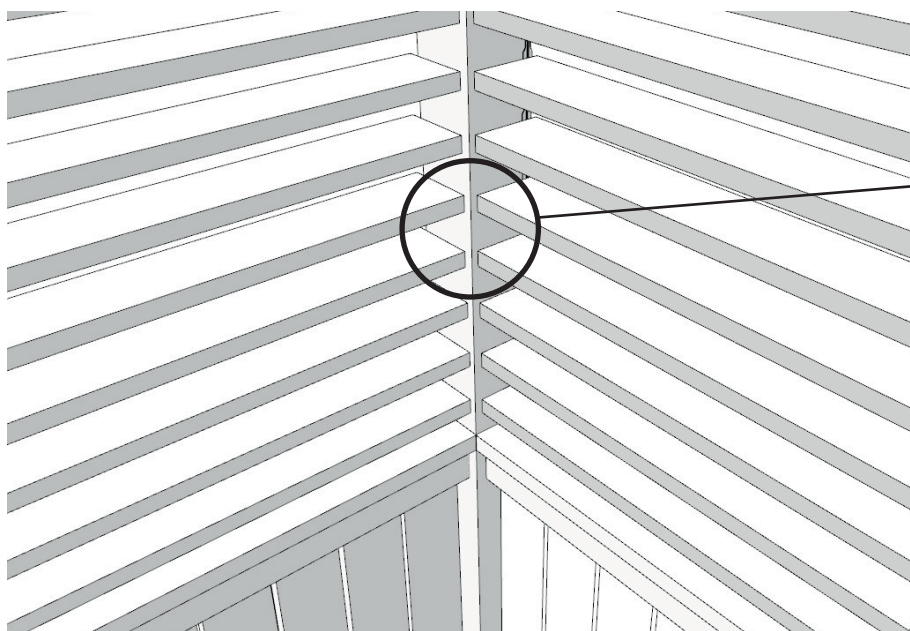

**DO NOT CUT  
CORNERS WITH  
A 6" X 6" POST  
STRUCTURE**



## RATE US!



### **Satisfied with your Pylex product?**

Please let us know by sharing pictures with us at [info@pylex.com](mailto:info@pylex.com)

You can also write a review online  
about your purchase.

*(By sending your image, you agree to give Pylex the right to it in its marketing activities).*

*Thank you !*

---

### **YOU LIKED OUR PRODUCT?**

Visit our website: [www.pylex.com](http://www.pylex.com) to see all our products  
or **scan this QR code** to have access to our catalog!



### **Pylex Guarantee Certificate**



Follow us on:

